

S-4L-285/10**Weidmüller Interface GmbH & Co. KG**

Klingenbergstraße 26

D-32758 Detmold

Germany

www.weidmueller.com

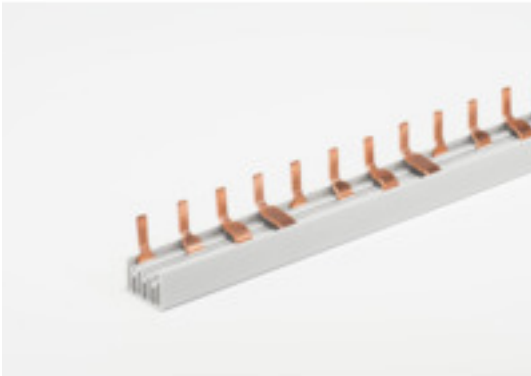
Product image

4-pole pin-type phase distribution bars are used for potential distribution to other components in the control cabinet such as circuit breakers, residual current circuit breakers and other installation devices.

General ordering data

Order No.	2658870000
Type	S-4L-285/10
GTIN (EAN)	4050118671650
Qty.	20 pc(s).

Data sheet

S-4L-285/10

Weidmüller Interface GmbH & Co. KG
 Klingenbergstraße 26
 D-32758 Detmold
 Germany

www.weidmueller.com

Technical data

Dimensions and weights

Depth	20.2 mm	Depth (inches)	0.795 inch
Height	27.5 mm	Height (inches)	1.083 inch
Width	285 mm	Width (inches)	11.22 inch
Net weight	35.75 g		

Material data

Colour	grey
--------	------

Dimensions

Pitch in mm (P)	17.8 mm
-----------------	---------

General

Number of poles	16
-----------------	----

Rating data

Rated cross-section	10 mm ²	Rated current	63 A
---------------------	--------------------	---------------	------

Classifications

ETIM 6.0	EC000489	ETIM 7.0	EC000489
ETIM 8.0	EC000489	ETIM 9.0	EC000489
ECLASS 9.0	27-14-11-40	ECLASS 9.1	27-14-11-40
ECLASS 10.0	27-14-11-40	ECLASS 11.0	27-14-11-40
ECLASS 12.0	27-14-11-40	ECLASS 13.0	27250303

Approvals

Approvals	
ROHS	Conform

Downloads

Approval/Certificate/Document of Conformity	CE Declaration of Conformity
Catalogues	Catalogues in PDF-format

Data sheet

S-4L-285/10

Weidmüller Interface GmbH & Co. KG
Klingenbergstraße 26
D-32758 Detmold
Germany

www.weidmueller.com

Drawings

Drawing

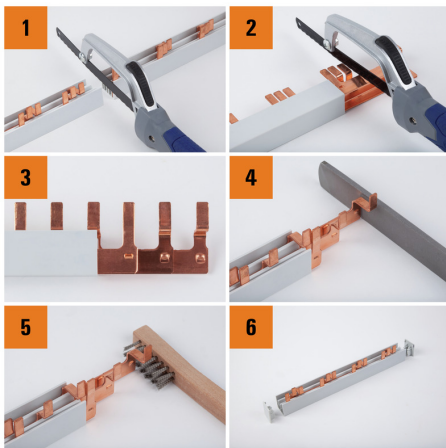
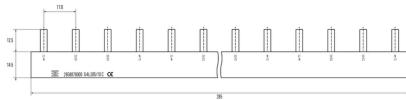

S-4L-285/10

Weidmüller Interface GmbH & Co. KG
 Klingenbergstraße 26
 D-32758 Detmold
 Germany

www.weidmueller.com

Accessories

Feed in terminals



Our feed-in modules facilitate handling when feeding the system. For example, the bending radius of the cable can be reduced by using a feed-in module with side entry.

General ordering data

Type	FIT 25 SN
Order No.	2659060000
GTIN (EAN)	4050118671476
Qty.	10 pc(s).
Type	FIT 50 GN/F
Order No.	2659090000
GTIN (EAN)	4050118671445
Qty.	3 pc(s).
Type	FIT 25 GN
Order No.	2659050000
GTIN (EAN)	4050118671483
Qty.	10 pc(s).
Type	FIT 50 GN
Order No.	2659070000
GTIN (EAN)	4050118671469
Qty.	3 pc(s).
Type	FIT 50 SN
Order No.	2659080000
GTIN (EAN)	4050118671452
Qty.	3 pc(s).
Type	FIT 50 SN/F
Order No.	2659100000
GTIN (EAN)	4050118671438
Qty.	3 pc(s).

S-4L-285/10

Weidmüller Interface GmbH & Co. KG
Klingenbergstraße 26
D-32758 Detmold
Germany

www.weidmueller.com

Accessories**End caps and covers**

End caps and covers ensure the required creepage distances in the system even after the bus bars have been cut to length or in the case of free-standing contacts, and guarantee finger safety in accordance with DIN EN 50274.

General ordering data

Type	END CAP G+S 4L/10
Order No.	2659010000
GTIN (EAN)	4050118671513
Qty.	10 pc(s).

Type	PROTECTION COVER G+S /5
Order No.	2659040000
GTIN (EAN)	4050118671490
Qty.	10 pc(s).