

RoHS
Compliant

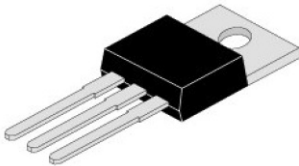

Applications

- Intended for a wide variety of Switching and Amplifier Applications
- Series and Shunt Regulators
- Driver and Output stages of Hi-Fi Amplifiers

Absolute Maximum Ratings ($T_a = 25^\circ\text{C}$)

Description	Symbol	BD241C	Unit
Collector Emitter Voltage	V_{CEO}	100	V
Collector Base Voltage	V_{CBO}	115	
Collector Emitter Voltage (RBE=100fi)	V_{CER}	115	
Emitter Base Voltage	V_{EBO}	5	
Collector Current Continuous	I_C	5	A
Collector Current Peak	I_{CM}	8	
Base Current	I_B	1	
Power Dissipation upto $T_C=25^\circ\text{C}$	P_D	40	W
Power Dissipation upto $T_a=25^\circ\text{C}$		2	
Derate above 25°C		16	mW/ $^\circ\text{C}$
Storage Temperature	T_{stg}	- 65 to +150	$^\circ\text{C}$
Junction Temperature	T_j	150	
Thermal Characteristics			
Junction to Case	$R_{th(j-c)}$	3.12	$^\circ\text{C}/\text{W}$
Junction to Ambient in free air	$R_{th(j-a)}$	62.5	

Electrical Characteristics

Parameter	Symbol	Test Condition	Min.	Max.	Unit
Collector Emitter (sus) Voltage	*V _{CEO(sus)}	I _C =30mA, I _B =0	100	--	V
Collector Cut Off Current	I _{CEO}	V _{CE} =60V I _B =0	--	0.3	mA
Collector Cut Off Current	I _{CES}	V _{CE} =V _{CEO(max)}	--	0.2	
Emitter Cut Off Current	I _{EBO}	V _{EB} =5V, I _C =0	--	1	
DC Current Gain	*h _{FE}	I _C =1A, V _{CE} =4V	25	--	--
		I _C =3A, V _{CE} =4V	10	--	--
Collector Emitter Saturation Voltage	*V _{CE(sat)}	I _C =3A, I _B =0.6A	--	1.2	V
Base Emitter On Voltage	*V _{BE(on)}	I _C =3A, V _{CE} =4V	--	1.8	
*Pulse Test : Pulse width <300ms, Duty Cycle <2%					
Dynamic Characteristic					
Small Signal Current Gain	h _{fe}	I _C =0.5A, V _{CE} =10V	20	--	--
Transition Frequency	f _T	I _C =0.5A, V _{CE} =10V	3		MHz
Turn Off Breakdown Energy	E _(BR)	L=20mH, I _{CC} =1.22A PNP	15		--
		L=20mH, I _{CC} =1.8A NPN	32		
Switching Characteristics					
Turn On Time	t _{on}	V _{CC} =20V, I _C =1A,	0.3		μS
Turn Off Time	t _{off}	I _{B1} =I _{B2} =0.1A	1		

Typical Characteristics Curves

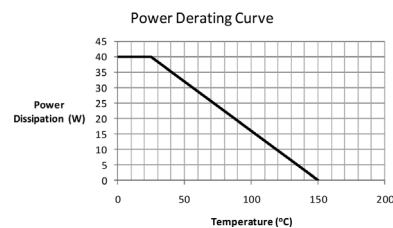
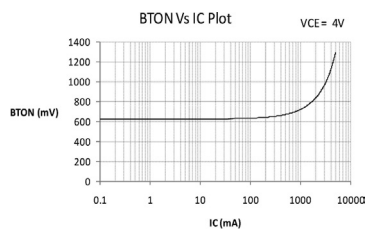
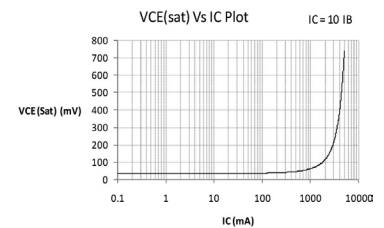
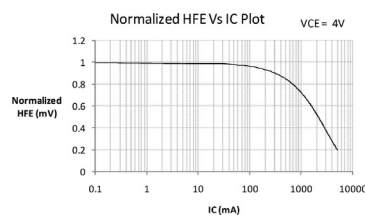
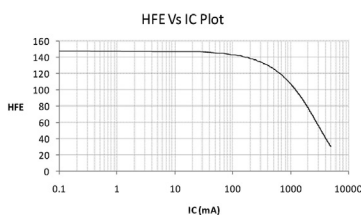

Diagram

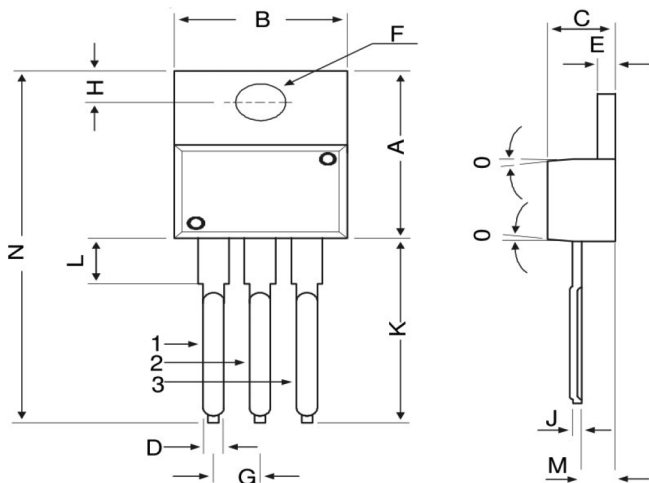

DIM	MIN	MAX
A	14.2	16.51
B	9.63	10.67
C	3.56	4.83
D	--	0.9
E	1.15	1.4
F	3.75	3.88
G	2.29	2.79
H	2.54	3.43
J	--	0.56
K	12.7	14.73
L	2.8	4.07
M	2.03	2.92
N	--	31.24
O	7 DEG.	

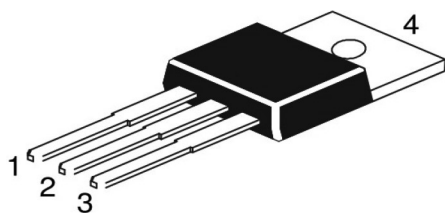

Pin Configuration

1. Base
2. Collector
3. Emitter
4. Collector

Part Number Table

Description	Part Number
Signle Bipolar Transistor, NPN, 40V, 4A, 100V, TO-220	BD241C

Dimensions : Millimetres

Important Notice : This data sheet and its contents (the "Information") belong to the members of the AVNET group of companies (the "Group") or are licensed to it. No licence is granted for the use of it other than for information purposes in connection with the products to which it relates. No licence of any intellectual property rights is granted. The Information is subject to change without notice and replaces all data sheets previously supplied. The Information supplied is believed to be accurate but the Group assumes no responsibility for its accuracy or completeness, any error in or omission from it or for any use made of it. Users of this data sheet should check for themselves the Information and the suitability of the products for their purpose and not make any assumptions based on information included or omitted. Liability for loss or damage resulting from any reliance on the Information or use of it (including liability resulting from negligence or where the Group was aware of the possibility of such loss or damage arising) is excluded. This will not operate to limit or restrict the Group's liability for death or personal injury resulting from its negligence. Multicomp Pro is the registered trademark of Premier Farnell Limited 2019.