

Photo-electric sensors

Osiris® Universal, Osiconcept®⁽¹⁾

Compact design

Five-wire, a.c. or d.c. supply, 1 NC/NO relay output

Three-wire, d.c. supply, solid-state output

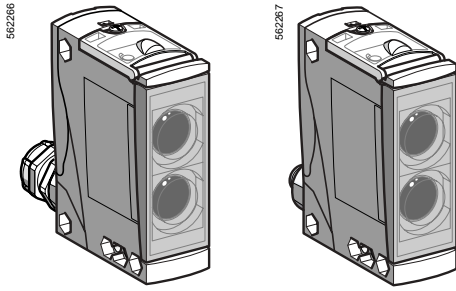

XUX 0ARCTT16

XUX 0AKSAM12

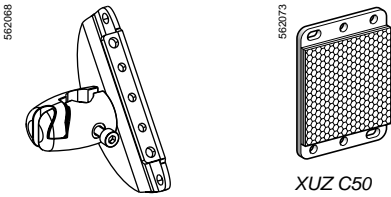

XUZ X2003

XUZ C50

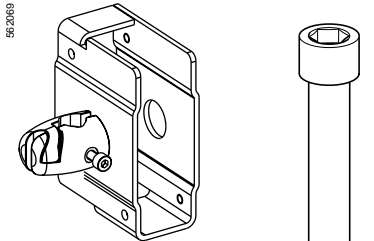

XUZ X2004

XUZ 2001

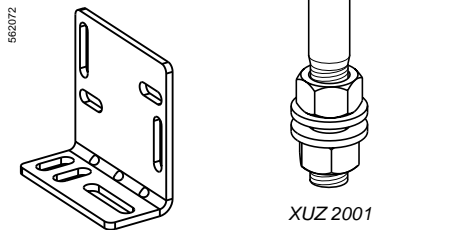

XUZ X2000

XUZ 2003

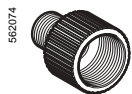

XUZ X2001

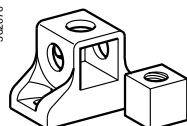

References

d.c. supply

Sensing distance (Sn) m	Function	Output	Connection (pre-cabled or connector)	Reference	Weight kg
0...40 depending on whether accessories are used	N/O or N/C using Osiconcept programming	PNP/NPN	Screw terminals – ISO 16 cable gland (3)	XUX 0AKSAT16	0.200
			M12 connector	XUX 0AKSAM12	0.200

Accessories

Description	Connection (pre-cabled or connector)	Reference	Weight kg
Thru-beam accessories	Screw terminals – ISO 16 cable gland (3)	XUX 0AKSAT16T	0.200
	M12 connector	XUX 0AKSAM12T	0.200

Reflector 50 x 50 mm	–	–	XUZ C50	0.020
----------------------	---	---	---------	-------

d.c. or a.c. supply

Sensing distance (Sn) m	Function	Output	Connection (pre-cabled or connector)	Reference	Weight kg
0...40 depending on whether accessories are used	N/O or N/C using Osiconcept programming	Time delay relay	Screw terminals – ISO 16 cable gland (3)	XUX 0ARCTT16	0.200

Accessories

Description	Connection (pre-cabled or connector)	Reference	Weight kg
Thru-beam accessory	Screw terminals – ISO 16 cable gland (3)	XUX 0ARCTT16T	0.200

Reflector 50 x 50 mm			XUZ C50	0.020
----------------------	--	--	---------	-------

Fixing accessories (2)

Description	Reference	Weight kg
3D fixing kit for use on M12 rod for XUX or XUZ C50	XUZ X2003	0.220
3D fixing kit for use on M12 rod and with protective cover for XUX	XUZ X2004	0.420
M12 rod	XUZ 2001	0.050
Support for M12 rod	XUZ 2003	0.150
Mounting bracket	XUZ X2000	0.120
Adaptor for ISO 16 - 1/2" NPT	XUZ X2001	0.050
Adaptor for ISO 16 - ISO 20	XUZ X2002	0.050

(1) For further information on Osiconcept, see page 37011/2.

(2) For further information, see page 37012/2.

(3) For Ø 7 to 10 mm cable.

Dimensions

XUX ●●●●T16

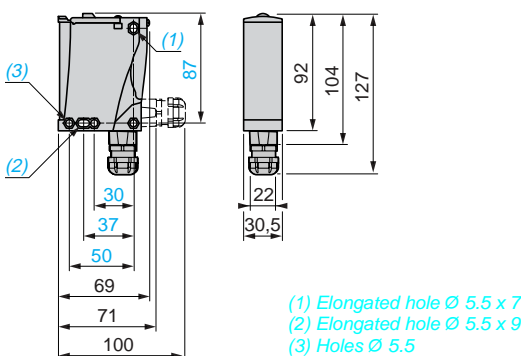

XUX ●●●●M12

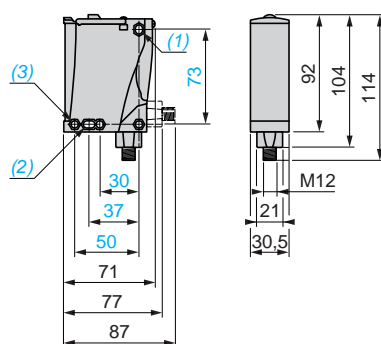

Indexation of the elbowed connector (rear view)

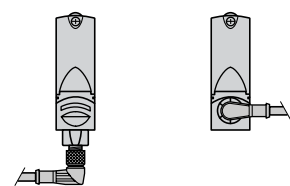

Photo-electric sensors

Osiris® Universal, Osiconcept®

Compact design

Five-wire, a.c. or d.c. supply, 1 NC/NO relay output

Three-wire, d.c. supply, solid-state output

Characteristics

		XUX ●●●●M12	XUX ●●●●T16
Sensor type		M12 connector	
Product certifications		UL, CSA, cE	
Connection		M12 connector	Screw terminals, ISO 16 cable entry gland
Sensing distance		1.3 / 1.3 without accessory (diffuse system with background suppression)	
nominal Sn / maximum		2 / 3 without accessory (diffuse system)	
(excess gain = 2) (excess gain = 1)		11 / 15 with reflector (polarised reflex)	
		40 / 60 with thru-beam accessory (thru-beam)	
Type of transmission		Infrared, except for polarised reflex (red)	
Degree of protection		Conforming to IEC 60529	IP 67, double insulation
Storage temperature range		°C - 40...+ 70	
Operating temperature range		°C - 25...+ 55	
Materials		Case	PBT
		Lens	PMMA
Vibration resistance		Conforming to IEC 60068-2-6	
Shock resistance		Conforming to IEC 60067-2-27	
Indicator lights		Output state	Yellow LED (transmission present for XUX 0●●●●●●T)
		Supply on	Green LED
		Instability	Red LED except for XUX 0●●●●●●T)
Rated supply voltage		PNP/NPN	V 12...24 --- with protection against reverse polarity
		Relay	V - 24...240 ~ or ---
Voltage limits (including ripple)		PNP/NPN	V 10...36 ---
		Relay	V - 20...264 ~ or ---
Current consumption, no-load		PNP/NPN	mA ≤ 35 (20 for XUX 0●●●●●●T)
Power consumption		Relay	W - 2 ~ or ---
Alarm output		mA	≤ 100 mA with overload and short-circuit protection
Switching capacity		PNP/NPN	mA ≤ 100 mA with overload and short-circuit protection
		Relay	A - 500,000 operating cycles 3 A: cos φ = 1/0.5 A: cos φ = 0.4
Voltage drop, closed state		V	≤ 1.5
Maximum switching frequency		PNP/NPN	Hz 240
		Relay	Hz - 20
Time delays		Relay	s - 0.02...15
Delays		First-up	ms < 200
		Response	ms < 2 (PNP/NPN); < 25 (relay output)
		Recovery	ms < 2 (PNP/NPN); < 25 (relay output)

Connections

M12 connector	Relay output ~	PNP / NPN ---	Transmitter ---	Transmitter ~
	Terminals	M12 Terminals	M12 Terminals	Terminals
	1 ⊗ ~	1 ● 1 ⊗ +	1 ● 1 ⊗ +	1 ⊗ ~
	2 ⊗ ~	3 ● 2 ⊗ -	3 ● 2 ⊗ -	2 ⊗ ~
	3 ⊗ N/O	4 ● 3 ⊗ Output	2 ● 3 ⊗ Beam broken input	
	4 ⊗ Relay common	2 ● 4 ⊗ Alarm		
	5 ⊗ N/C			

See connection on page 302/10/2.

Maximum permissible conductor section: 1 x 1.5 mm² or 1 x 0.75 mm² with adaptor.

Detection curves

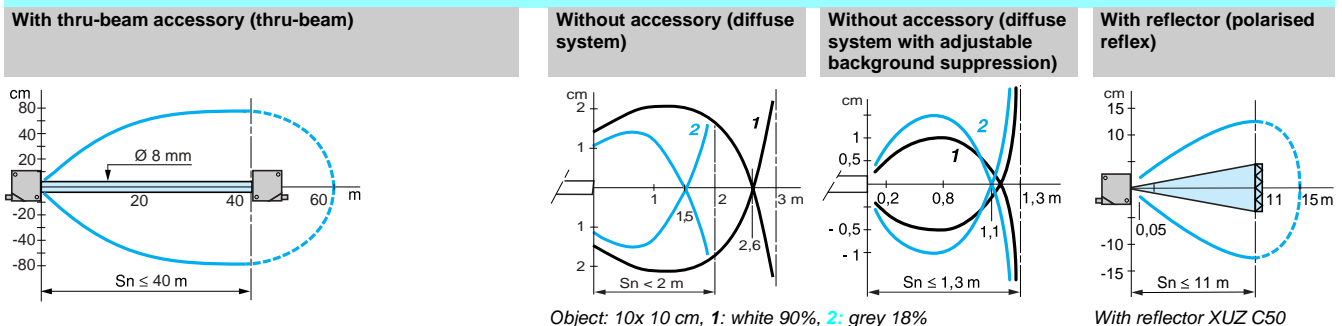

Variation of usable sensing distance Su (without accessory with adjustable background suppression)

