

H:9 B: CFA 5HC B 7 C BH 5 B 98 B H K 6 8F5K B: 6 H 9 GC @ DFC D9FHMC:
 @7 C A Z B 7 5 B MF 9DFC 8I 7 HC BG B D5FHC F K < C @ K H: C I H: K 9 K F H 9 B
 D9FA 6GC B C: @7 C A Z B 7 5 DFC < 6 H 9 8

F c < G 7 ca d`Jubh'U

F9J 6C BG			
F9J	89G7 F 4HC B	85H9	7 < 5B: 98 6M
9	97B 7) * && FC15H98 @7 CA @C: C % \$S	+ #8 9 9%	B 7 5 GFC
:	97 B * & + 1 D85H98 @C: CG5B8: CFA 5H	S: # % # %	B: D
!		!	!
!		!	!

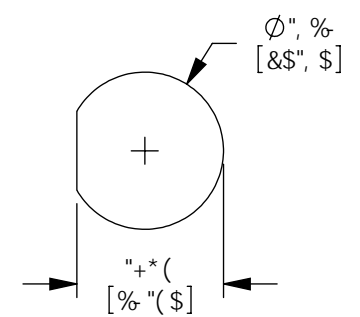

F97 C A A 9B 8 98
 D5B 9 @ C D9B B:

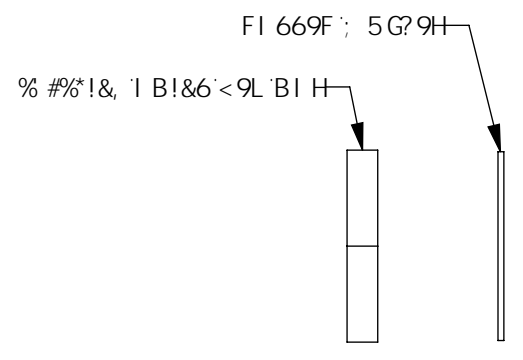

BI H5B8; 5G? 9HG < C K B B
 H: 6 J 9 K C B @ M: C F 7 @ F H M

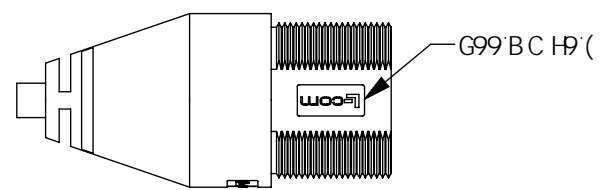
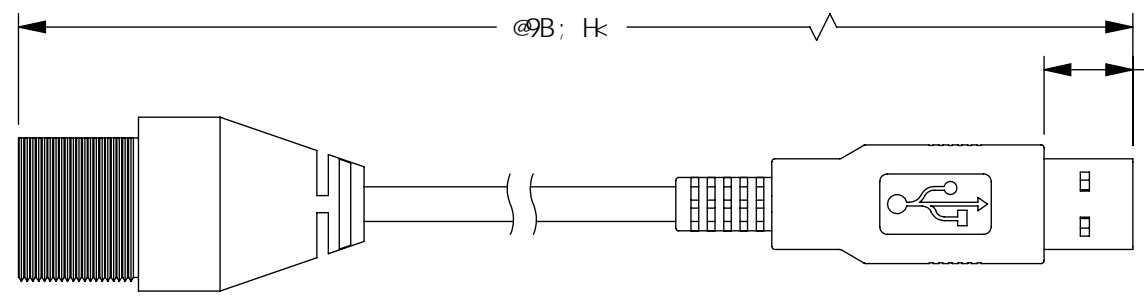

G99 BC H9 (

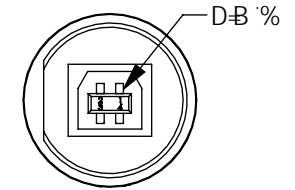

" > %"
 I G6 G9F 9G 6
 F97 9DH5 7 @

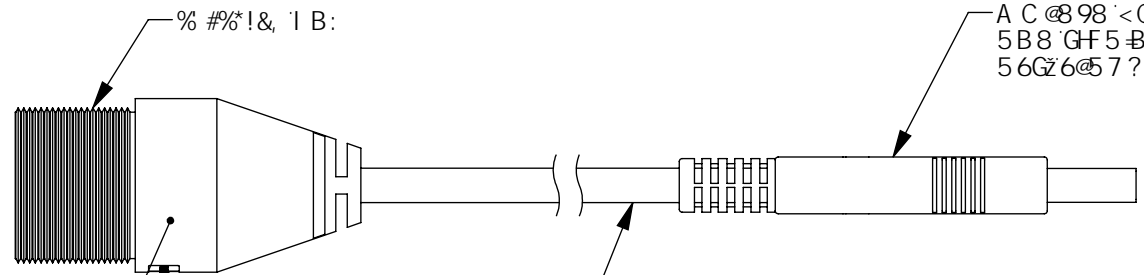

K 5 H F D F C C: < C I G B:
 6 @ 7 ? 5 6 G I @ (J I \$
 f H D * + F 5 H 9 8 L

C B 9 &, 5 K; GF5 B 8 98 H B B 98 7 C D D 9 F H K 6 H 9 8 D 5 F
 H K C & (5 K; GF5 B 8 98 H B B 98 7 C D D 9 F 7 C B 8 I 7 H C F G
 C J 9 F 5 @ @ 5 @ A B A 9 8 D C @ M G H F G < 9 @ K H: 8 F 5 B:
 K F 9 D @ G H B B 9 8 7 C D D 9 F 6 F 5 8 9 8 G < 9 @ B
 D J 7 C I H 9 F > 5 7 ? 9 H z 6 @ 7 ?

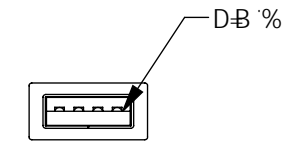

" D %"
 I G 6 G 9 F 9 G 5
 D @ ;

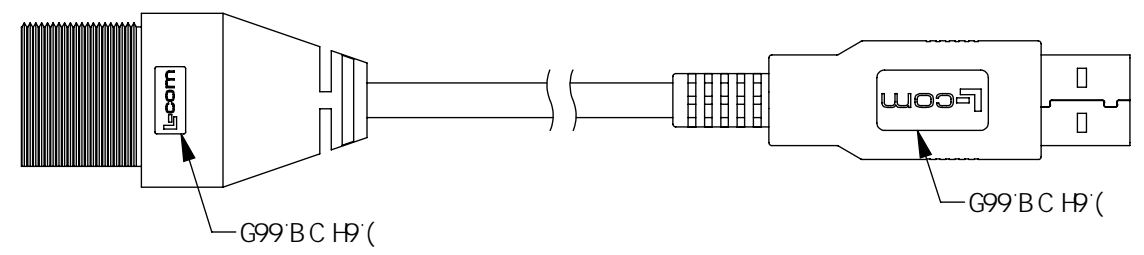
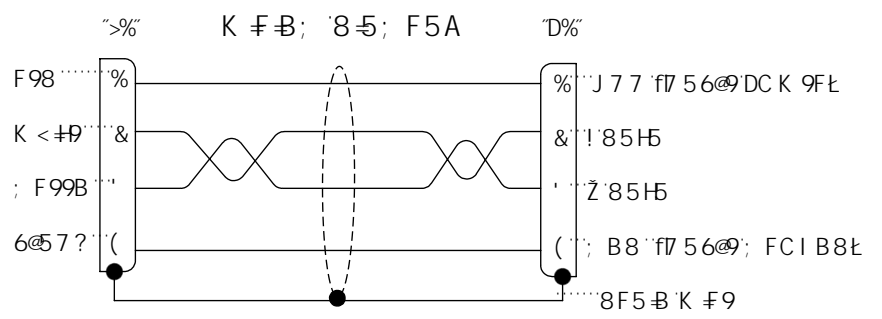

G99 BC H9 (

BC H9 G
 % " H: 9 G 9 7 5 6 @ 5 G 9 A 6 @ 9 G 5 F 9 7 C B G F I 7 H 9 8 H C A 9 9 H I K 9
 " " " F 9 E I F 9 A 9 B H G C: H: K 9 I B J 9 F G 5 @ 9 F 5 @ 6 I G G D 9 7 = 7 5 H C B
 " " " I G 6 & \$"
 & " 7 C B B 9 7 H C F 7 C B H 5 7 H G < 5 J 9 " \$ + B 7 < 9 G: C @
 " " " D 5 H B: C J 9 F B 7 ? 9 @ D 5 H B: "
 " " " H: 9 7 5 6 @ 9 G < 9 @ 8 8 F 5 B K F 9 6 7 C B B 9 7 H 9 8 H C H: K 9
 " " " A 9 H 5 @ G < 9 @ C: 9 5 7 < D @ ; "
 (" " " H: 9 " @ 7 C A " @ C: C 6 9 A 6 C G G 9 8 B 5 F 9 7 9 G G 9 8 D C 7 ? 9 H " H: K 9
 " " " F 5 6 9 8 @ C: C G < C I @ B C H D F C > 9 7 H 6 9 M C B 8 H: 9 C J 9 F A C @
 " " " G I F: 5 7 9"
) " " 7 5 6 @ 5 G 9 A 6 @ M G < 5 @ 6 9 H 9 G H 9 8: C F 7 C B H B I H M
 * " " 7 5 6 @ 5 G 9 A 6 @ M G < 5 @ 6 9 B 8 J B I 5 @ M D 5 7 ? 5; 9 8 B
 " " " 5 7 7 C F 8 5 B 7 9 K H: @ 7 C A G D 9 7 = 7 5 H C B D G I \$ \$ ' %"

MODEL NUMBER	LENGTH	
	METER	FEET
WPUSBBA-05M	0.5	1.64
WPUSBBA-1M	1.0	3.28
WPUSBBA-2M	2.0	6.56
WPUSBBA-3M	3.0	9.84
WPUSBBA-5M	5.0	16.41

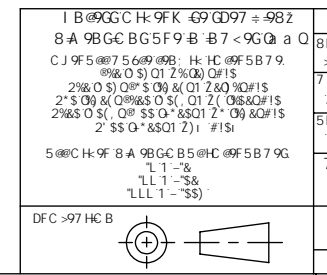

I B @ G G C H: 9 F K 6 9 @ D 9 7 = 9 8 z 8 A 9 B G C B G 5 F 9 B B 7 < 9 G @ a O C J 9 F 5 @ 7 5 6 @ 9 8: H: H C @ F 5 B 7 9 % & O S) O I 2 % O) O F I S 2 % O S) O 9 S O 9 8 (O I 2 & O % O F I S 2 * S O 9 8 (O % 8 5 O S (O I 2 (O 8 8 O F I S 2 % 8 5 O S (O 9 S S O 8 8 O I 2 * O 9 8 O F I S 2 * S S O * 8 8 O I 2) I # I S	5 D D F C J 5 @ G	8 5 H 9
5 @ C H: 9 F 8 A 9 8 G C B 5 @ H C @ F 5 B 7 9 G L L 1 - & L L L 1 - \$ S	7 C B: = I F 5 H C B 8 9 H 5 @ C C: I B 8 A 9 8 G C B 9 8: 9 5 H F 9 G A 5 M J 5 F M	7 C @ F J 5 F 5 H C B G A 5 M C 7 7 I F

L-com Global Connectivity () 6997 < K C C 8 8 F 9 9
 B C F H: 5 B 8 C J 9 F Z A 5
 \$ % ()

75H9: CFM I G6

DFC 8 I 7 H 8 9 7 F 4 H C B

7 6 @ K H F D F: I G 6 I: # 5 ! A

G99	G7 A B C *	8K: " B C *	F9J *
6	(' & %	K D I G 6 6 5	:

G7 5 @ 9: % % 7 5 B: @ 9: K D I G 6 6 5 G 8 8 B F K G: 9 9 H % C: %