

THE INFORMATION CONTAINED IN THIS DRAWING IS THE SOLE PROPERTY OF L-COM, INC. ANY REPRODUCTION IN PART OR WHOLE WITHOUT THE WRITTEN PERMISSION OF L-COM, INC. IS PROHIBITED.

REVISIONS			
REV	DESCRIPTION	DATE	APPROVED
E	ECN8674: REVISE STRAIN RELIEF FROM 2 PCS TO 1PC TYP. IN THE PNL MNT END.	03/15/2017	B.ZHANG

PART NUMBER	LENGTH	
	INCHES	MM
ECF504-12AAL	12.0	[304.8]
ECF504-24AAL	24.0	[609.6]
ECF504-36AAL	36.0	[914.4]
ECF504-72AAL	72.0	[1828.8]
ECF504-120AAL	120.0	[3048.0]

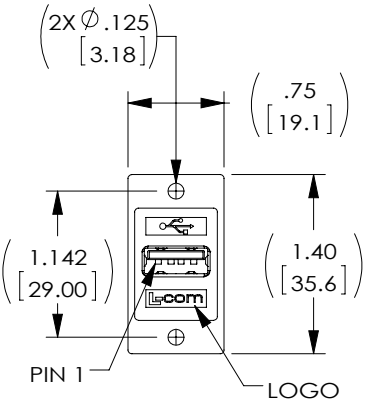
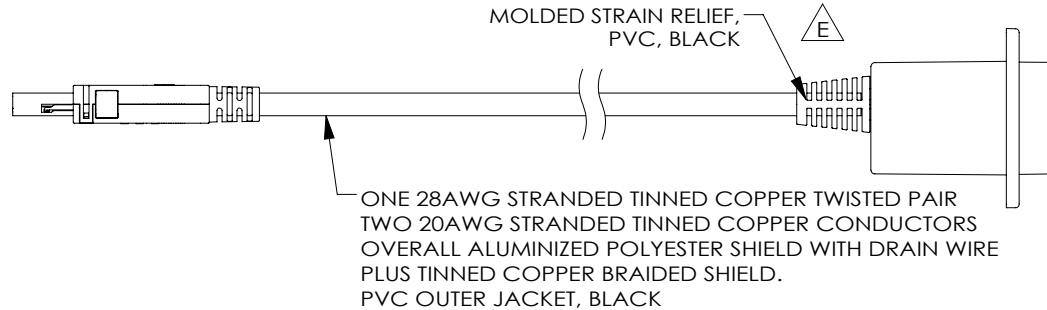
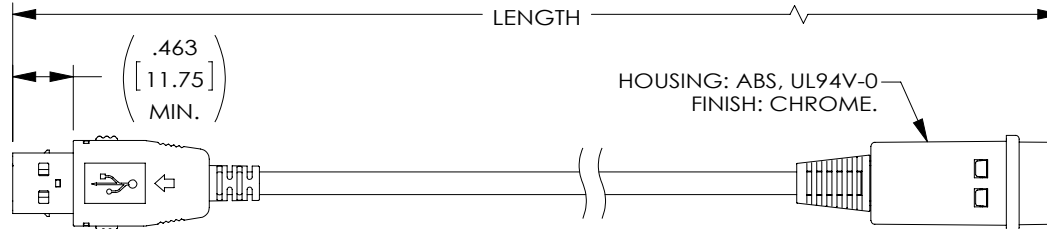

"J1"  
USB SERIES "A" RECEPTACLE  
BULKHEAD ADAPTOR  
CONTACTS: 30 μINCHES  
GOLD PLATING

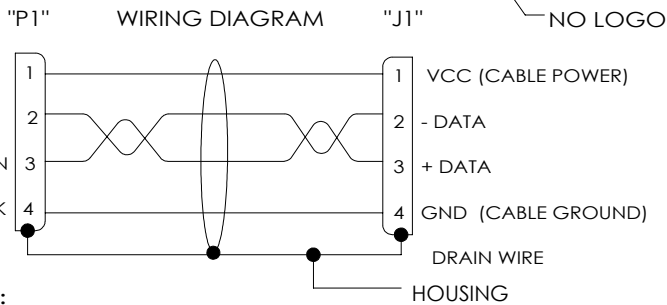
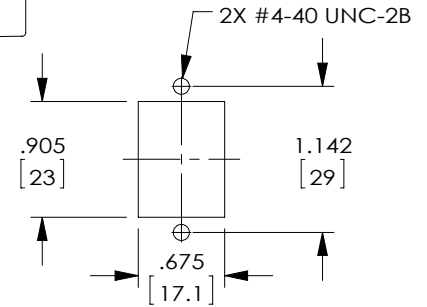
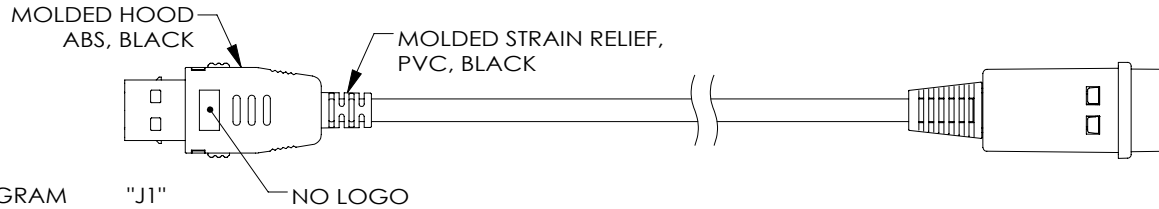
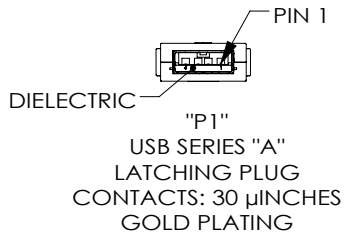

**NOTES:**

1. OPERATING TEMPERATURE: -10°C TO +70°C
2. CABLE ASSEMBLY SHALL HAVE 360° SHIELD TERMINATION.
3. CABLE ASSEMBLY SHALL MEET USB 2.0 REQUIREMENTS.
4. CABLE ASSEMBLY SHALL BE TESTED FOR CONTINUITY.
5. CABLE ASSEMBLY SHALL BE INDIVIDUALLY PACKAGED IN ACCORDANCE WITH L-COM SPECIFICATION PS-0031.

**REGULATORY COMPLIANCE:**  
CE2011/65/EU (RoHS DIRECTIVE)

UNLESS OTHERWISE SPECIFIED, DIMENSIONS ARE IN INCHES [mm] OVERALL CABLE LENGTH TOLERANCE: ≤12 [305] = +1 [25] / -0 >12 [305] ≤60 [1524] = +2 [51] / -0 >60 [1524] ≤120 [3048] = +4 [102] / -0 >120 [3048] ≤300 [7620] = +6 [152] / -0 >300 [7620] = +3% / -0%	APPROVALS	DATE
	DRAWN BY D. DESJARDIN	10/24/12
	CHECKED BY R. SCOTT	10/24/12
	APPROVED BY S. SMITH	10/24/12
ALL OTHER DIMENSIONAL TOLERANCES: .X = ± .2 [5.08] .XX = ± .02 [1.51] .XXX = ± .005 [1.27]	CONFIGURATION DETAILS OF UNDIMENSIONED FEATURES MAY VARY	
PROJECTION	COLOR VARIATIONS MAY OCCUR	

<b>L-com</b> Global Connectivity		50 HIGH STREET NORTH ANDOVER, MA 01845	
CATEGORY		USB	
PRODUCT DESCRIPTION			
USB A-F PNL MNT/A LTCH-M			
SIZE <b>A</b>	FSCM NO. <b>43321</b>	DWG. NO. <b>ECF504-AAL</b>	REV. <b>E</b>
SCALE: NONE		CAD FILE: ECF504-AAL.SLDDRW	
			SHEET 1 OF 1