

ALPHA 40 mm profile semicylinder with "E012 lock" and 2x keys for floor-mounted distribution board

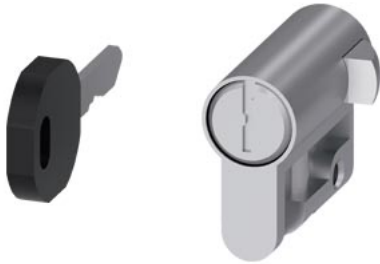

| Model | |
|-----------------------|----------------------|
| product brand name | ALPHA |
| product designation | Profile semicylinder |
| design of the product | For locking systems |
| material | steel |

| Mechanical Design | |
|-------------------|--------|
| Net Weight | 93.5 g |

| Approvals Certificates | | | |
|------------------------|--------------------------|-------------------|-------|
| Environment | General Product Approval | Test Certificates | other |

[Environmental Con-
firmations](#)

[Environmental Con-
firmations](#)



[Confirmation](#)

[Special Test Certifi-
cate](#)

[Confirmation](#)

other

[Miscellaneous](#)



Further information

Information on the packaging

<https://support.industry.siemens.com/cs/ww/en/view/109813875>

Information for data generation and storage

<https://support.industry.siemens.com/cs/ww/en/view/109995012>

Information- and Downloadcenter (Catalogs, Brochures,...)

<https://www.siemens.com/lowvoltage/catalogs>

Industry Mall (Online ordering system)

<https://mall.industry.siemens.com/mall/en/en/Catalog/product?mlfb=8GK9561-0KK00>

Service&Support (Manuals, Certificates, Characteristics, FAQs,...)

<https://support.industry.siemens.com/cs/ww/en/ps/8GK9561-0KK00>

Image database (product images, 2D dimension drawings, 3D models, device circuit diagrams, ...)

https://www.automation.siemens.com/bilddb/cax_en.aspx?mlfb=8GK9561-0KK00

CAx-Online-Generator

<https://www.siemens.com/cax>

Tender specifications

<https://www.siemens.com/specifications>

Characteristic curves

[https://curves.simaris.siemens.com/curves/<mmp_prod_noCOMP="HAUPT"></mmp_prod_no>](https://curves.simaris.siemens.com/curves/<mmp_prod_noCOMP=)

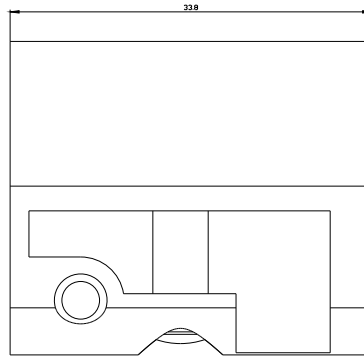
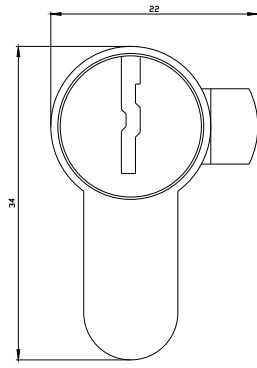

last modified:

8/22/2025 

