

## Mini installation beacon / LED Beacon 816

**LED Perm. Beacon EM 24VDC MC**

Part No.: 816.480.55

**MECHANICAL DATA**

|                             |                           |
|-----------------------------|---------------------------|
| Height                      | 97 mm                     |
| Diameter                    | 75 mm                     |
| Materials                   | PC                        |
| Dome colour                 | Clear                     |
| Protection category         | IP65                      |
| Connection                  | M12 plug 4-pole           |
| Tension relief              | Present (conforms to VDE) |
| Type of fixing              | Built-in mounting         |
| Working temperature minimum | -20°C                     |
| Working temperature maximum | +50°C                     |
| Weight with packaging       | 132 g                     |
| Product weight              | 110 g                     |

**ELECTRICAL DATA**

|                             |                           |
|-----------------------------|---------------------------|
| Operating voltage           | 24V                       |
| Operating voltage type      | DC                        |
| Operating voltage tolerance | +/- 10%                   |
| Rated operational voltage   | 24 VDC                    |
| Rated operational current   | 120 mA                    |
| Rated inrush current        | 500 mA                    |
| Protection class            | Protection class 2        |
| Pollution degree            | 3                         |
|                             | In the connection area: 2 |

**OPTICAL DATA**

|                      |                  |
|----------------------|------------------|
| Light source         | LED              |
| Light colour         | MC 7 colours     |
| Optical signal image | Permanent        |
| Service life optical | 50,000 h maximum |

**APPROVAL DATA**

|                             |         |
|-----------------------------|---------|
| Conforms with CE            | Yes     |
| WEEE                        | Yes     |
| Conform with ATEX-directive | No      |
| Conforms with CCC           | No      |
| Conforms with UL            | cULus   |
| UL Type Rating              | Type 12 |
| Conforms with FCC           | No      |
| Conforms with IC            | No      |

For additional installation and mounting information, refer to the appropriate user guide at [www.werma.com](http://www.werma.com). This printed copy is for information only and is subject to alteration.

## Mini installation beacon / LED Beacon 816

**LED Perm. Beacon EM 24VDC MC**

|                           |     |
|---------------------------|-----|
| EAC certificate available | Yes |
| Conforms with AS-I        | No  |
| ICAO Certification        | No  |
| Conforms with GL          | No  |
| Conforms with RoHS CN     | No  |
| Conforms with VdS         | No  |

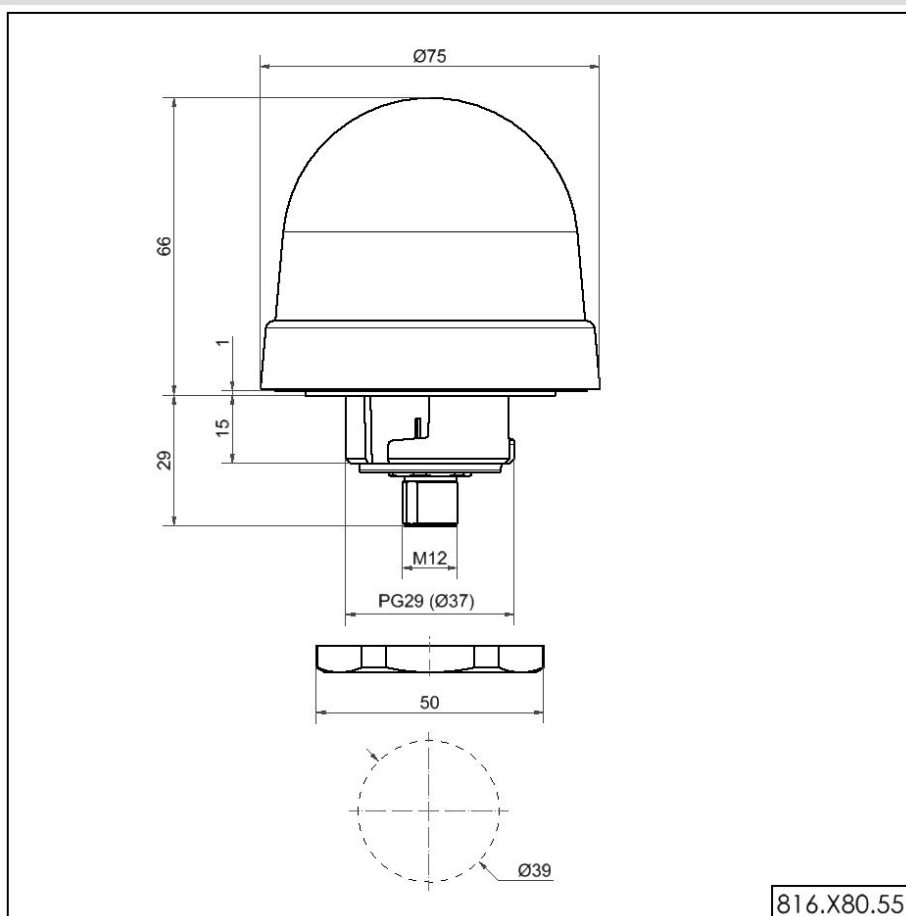
**DRAWING**

For additional installation and mounting information, refer to the appropriate user guide at [www.werma.com](http://www.werma.com). This printed copy is for information only and is subject to alteration.