

Data Sheet

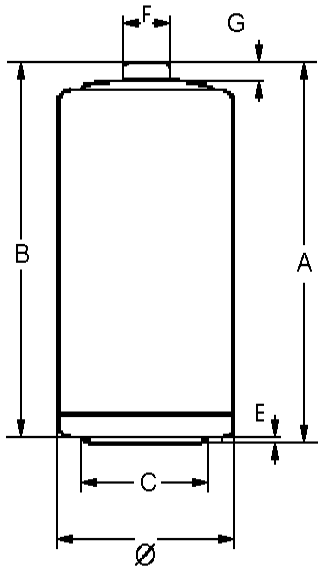

| | |
|-------------------------------|---------------------------------------|
| Type Designation | 4014 |
| Designation IEC | LR14 |
| System | Zn-MnO ₂ (Alkaline) |
| Shelf Life (Coding)* | 10 years |
| Nominal Voltage [V] | 1.5 |
| Typical Capacity C [mAh] | 7800 (discharge with high-resistance) |
| Permissible Temperature Range | - 20 °C ... 50 °C |
| Weight, approx. [g] | 65,8 |
| Volume [ccm] | 26 |

Dimensions [mm] min: max:

| | | |
|---|------|------|
| ∅ | 24.9 | 26.2 |
| A | - | 50.0 |
| B | 48.6 | - |
| C | 13.0 | - |
| E | - | 0.9 |
| F | - | 7.5 |
| G | 1.5 | - |

Typical Capacities (at 20°C):

| Discharge Type | Load | End Voltage[V] | 0.9 |
|-------------------|--------|----------------|------------|
| 4M/15M,8H/D,7D/W | 3.9 Ω | Time [h] | 22,1 |
| Portable Lighting | | Capacity [Ah] | 6,44 |
| | | Energy [Wh] | 7,38 |
| Discharge Type | Load | End Voltage[V] | 0.8 |
| 1H/D,7D/W | 3.9 Ω | Time [h] | 24,7 |
| Toy | | Capacity [Ah] | 6,80 |
| | | Energy [Wh] | 7,39 |
| Discharge Type | Load | End Voltage[V] | 0.9 |
| 2H/D,7D/W | 400 mA | Time [h] | 11,5 |
| Portable stereo | | Capacity [Ah] | 4,60 |
| | | Energy [Wh] | 5,02 |

* In consideration of typical loss of capacity at storage and application.

Information and contents in this data sheet are for reference purpose only.
 They do not constitute any warranty or representation and are subject to change without notice.
 For most current information and further details, please contact your VARTA representative.