



plug-in socket for RT relay standard plug-in socket screw terminal

product brand name	SIRIUS
product type designation	LZS
General technical data	
display version LED	No
reference code according to IEC 81346-2	U
Substance Prohibitance (Date)	05/01/2012
Net Weight	0.037 kg
Mechanical data	
product component plug-in socket	Yes
design of the snap-on socket base	Standard socket
design of the relay operating mechanism	poled
Auxiliary circuit	
number of NC contacts for auxiliary contacts	0
number of NO contacts for auxiliary contacts	0
number of CO contacts for auxiliary contacts	0
Connections/ Terminals	
product function removable terminal	No
type of electrical connection	screw terminal
type of connectable conductor cross-sections	
• solid	1x (1,0 ... 2,5), 2x 1,0, 2x 1,5, 2x 2,5
• finely stranded with core end processing	1x (1,0 ... 1,5), 2x 1,0, 2x 1,5
• for AWG cables solid	1x (18 ... 14), 2x 18, 2x 16, 2x 14
connectable conductor cross-section	
• solid	1 ... 2.5 mm ²
• finely stranded with core end processing	1 ... 1.5 mm ²
AWG number as coded connectable conductor cross section	
• solid	18 ... 14
tightening torque with screw-type terminals	0.5 ... 0.7 N·m
Installation/ mounting/ dimensions	
mounting position	any
fastening method	snap-on mounting
height	78 mm
width	15.5 mm
depth	42.3 mm
required spacing	
• with side-by-side mounting	
— forwards	0 mm
— backwards	0 mm

— upwards	0 mm
— downwards	0 mm
— at the side	0 mm
• for grounded parts	
— forwards	0 mm
— backwards	0 mm
— upwards	0 mm
— at the side	0 mm
— downwards	0 mm
• for live parts	
— forwards	0 mm
— backwards	0 mm
— upwards	0 mm
— downwards	0 mm
— at the side	0 mm

Ambient conditions

ambient temperature

• during operation	-40 ... +70 °C
• during storage	-20 ... +70 °C
• during transport	-20 ... +70 °C

Approvals Certificates

Environment	General Product Approval	other
Environmental Confirmations	 	 

[Confirmation](#)

other

[Confirmation](#)



Further information

Information on the packaging

<https://support.industry.siemens.com/cs/ww/en/view/109813875>

Information for data generation and storage

<https://support.industry.siemens.com/cs/ww/en/view/109995012>

Information- and Downloadcenter (Catalogs, Brochures,...)

<https://www.siemens.com/ic10>

Industry Mall (Online ordering system)

<https://mall.industry.siemens.com/mall/en/en/Catalog/product?mlfb=LZS:RT78725>

Cax online generator

<https://support.automation.siemens.com/WW/CAXorder/default.aspx?lang=en&mlfb=LZS:RT78725>

Service&Support (Manuals, Certificates, Characteristics, FAQs,...)

<https://support.industry.siemens.com/cs/ww/en/ps/LZS:RT78725>

Image database (product images, 2D dimension drawings, 3D models, device circuit diagrams, EPLAN macros, ...)

https://www.automation.siemens.com/bilddb/cax_de.aspx?mlfb=LZS:RT78725&lang=en

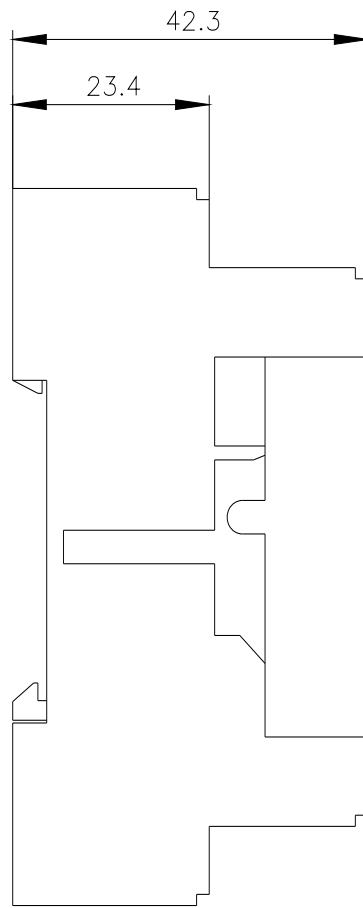
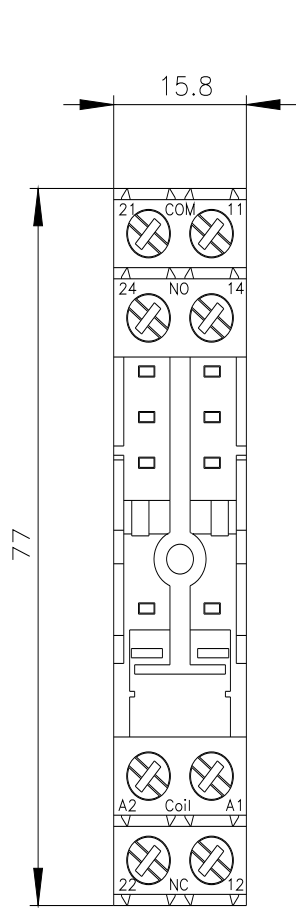



NSB0_01762a

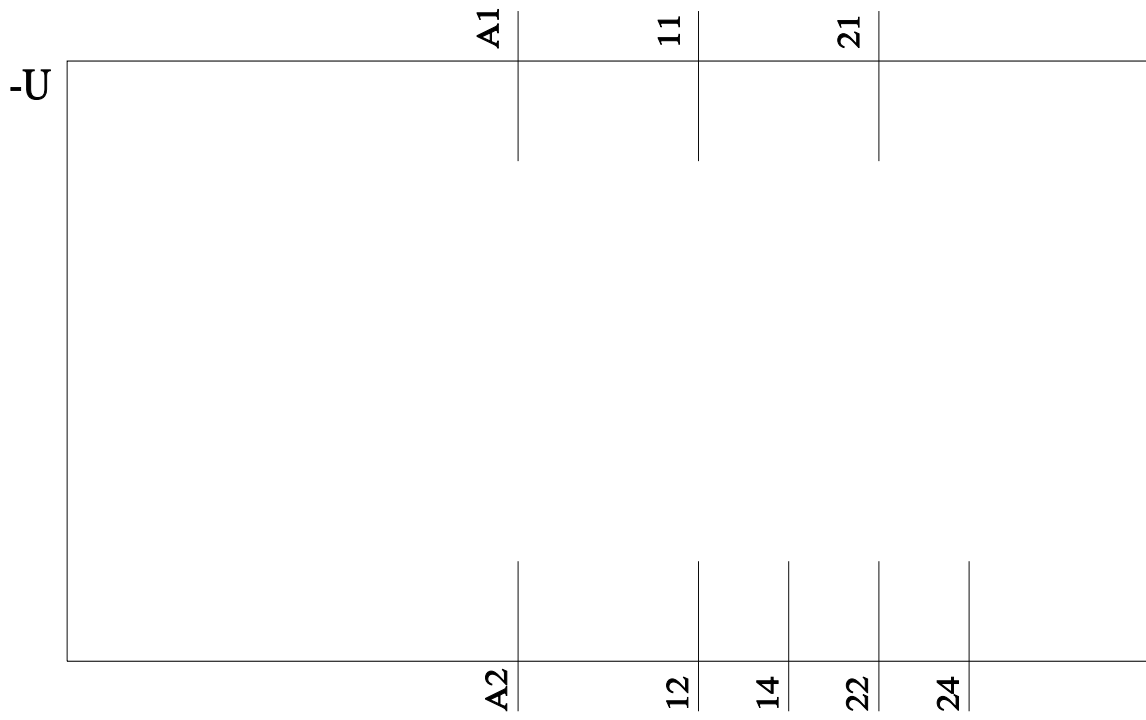

last modified:

10/22/2025 