

Pin busbar, 16 mm² 56 MW, 4-phase, can be cut for LS 2P and RCBO 1P+N touch-safe without end caps



Figure similar

product brand name	SENTRON
product designation	Pin busbar
design of the product	28x (1PH+N)
design of the phase tap	L1/N/L2/N/L3/N
General technical data	
compatibility	for RCBO or MCB 1P+N
design of pole	3P+N
phase number	4
operational current rated value	80 A
suitability for interaction devices with auxiliary switch	No
suitability for interaction devices with N conductor	Yes
suitability for use	RCCB 2P N right
color	light grey
Product details	
product component with end cap	No
product feature attachable arc fault detection device	No
product feature insulated	Yes
product function	
• suitable for compact devices	No
• can be cut	Yes
number of devices suitable for fitting	28
type of electrical connection	Pin
Mechanical Design	
module width	18 mm
height	17 mm
width	21 mm
length	1 000 mm
number of modular width units	56
cross-section	16 mm ²
angle of the pin of busbar	0°
Net Weight	770 g
Approvals Certificates	
Environment	General Product Approval

[Environmental Con-
firmations](#)

[Environmental Con-
firmations](#)

[Miscellaneous](#)



[Confirmation](#)



[Confirmation](#)[Miscellaneous](#)

Further information

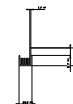
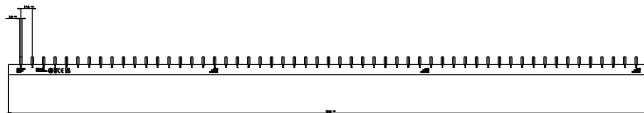
Information on the packaging<https://support.industry.siemens.com/cs/ww/en/view/109813875>**Information for data generation and storage**<https://support.industry.siemens.com/cs/ww/en/view/109995012>**Information- and Downloadcenter (Catalogs, Brochures,...)**<https://www.siemens.com/lowvoltage/catalogs>**Industry Mall (Online ordering system)**<https://mall.industry.siemens.com/mall/en/en/Catalog/product?mlfb=5ST3770-3>**Service&Support (Manuals, Certificates, Characteristics, FAQs,...)**<https://support.industry.siemens.com/cs/ww/en/ps/5ST3770-3>**Image database (product images, 2D dimension drawings, 3D models, device circuit diagrams, ...)**https://www.automation.siemens.com/bilddb/cax_en.aspx?mlfb=5ST3770-3**CAX-Online-Generator**<https://www.siemens.com/cax>**Tender specifications**<https://www.siemens.com/specifications>**Characteristic curves**[https://curves.simaris.siemens.com/curves/<mmp_prod_noCOMP="HAUPT"></mmp_prod_no>](https://curves.simaris.siemens.com/curves/<mmp_prod_noCOMP=)

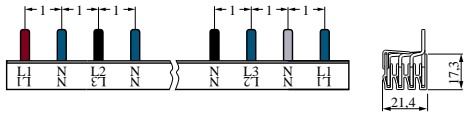

last modified:

1/15/2026 

