



adapter (plastic) between enclosure top and base of plastic enclosure with 1 command point for installation of 2-pole or two 1-pole stacked contact modules with front plate mounting or ID key-operated switch, , not suitable for enclosure 3SU1801-1AA00-1AA1

product brand name	SIRIUS ACT
product designation	Adapter
design of the product	between enclosure upper part and bottom part
product type designation	3SU1

General technical data

Substance Prohibition (day/month/year)	10/01/2014
Net Weight	78 g

Ambient conditions

ambient temperature	
<ul style="list-style-type: none"> during operation 	-25 ... +70 °C
<ul style="list-style-type: none"> during storage and transport 	-40 ... +80 °C

Installation/ mounting/ dimensions

height	22.5 mm
--------	---------

Accessories

material of accessory	Plastic
color of accessory	black

Approvals Certificates

Environmental Product Declaration	
<ul style="list-style-type: none"> global warming potential [CO2 eq] / during manufacturing global warming potential [CO2 eq] / during operation global warming potential [CO2 eq] / after end of life global warming potential [CO2 eq] / total 	<ul style="list-style-type: none"> 0.566 kg 0.235 kg -0.0145 kg 0.787 kg

Environment **General Product Approval**

[Environmental Confirmations](#)



General Product Approval **Test Certificates** **Maritime application**



[Type Test Certificates/Test Report](#)



[Confirmation](#)



Further information

Information on the packaging

<https://support.industry.siemens.com/cs/ww/en/view/109813875>

Information for data generation and storage

<https://support.industry.siemens.com/cs/ww/en/view/109995012>

Information- and Downloadcenter (Catalogs, Brochures,...)

<https://www.siemens.com/ic10>

Industry Mall (Online ordering system)

<https://mall.industry.siemens.com/mall/en/en/Catalog/product?mlfb=3SU1900-0JF10-0AA0>

Cax online generator

<https://support.automation.siemens.com/WW/CAXorder/default.aspx?lang=en&mlfb=3SU1900-0JF10-0AA0>

Service&Support (Manuals, Certificates, Characteristics, FAQs,...)

<https://support.industry.siemens.com/cs/ww/en/ps/3SU1900-0JF10-0AA0>

Image database (product images, 2D dimension drawings, 3D models, device circuit diagrams, EPLAN macros, ...)

https://www.automation.siemens.com/bilddb/cax_de.aspx?mlfb=3SU1900-0JF10-0AA0&lang=en

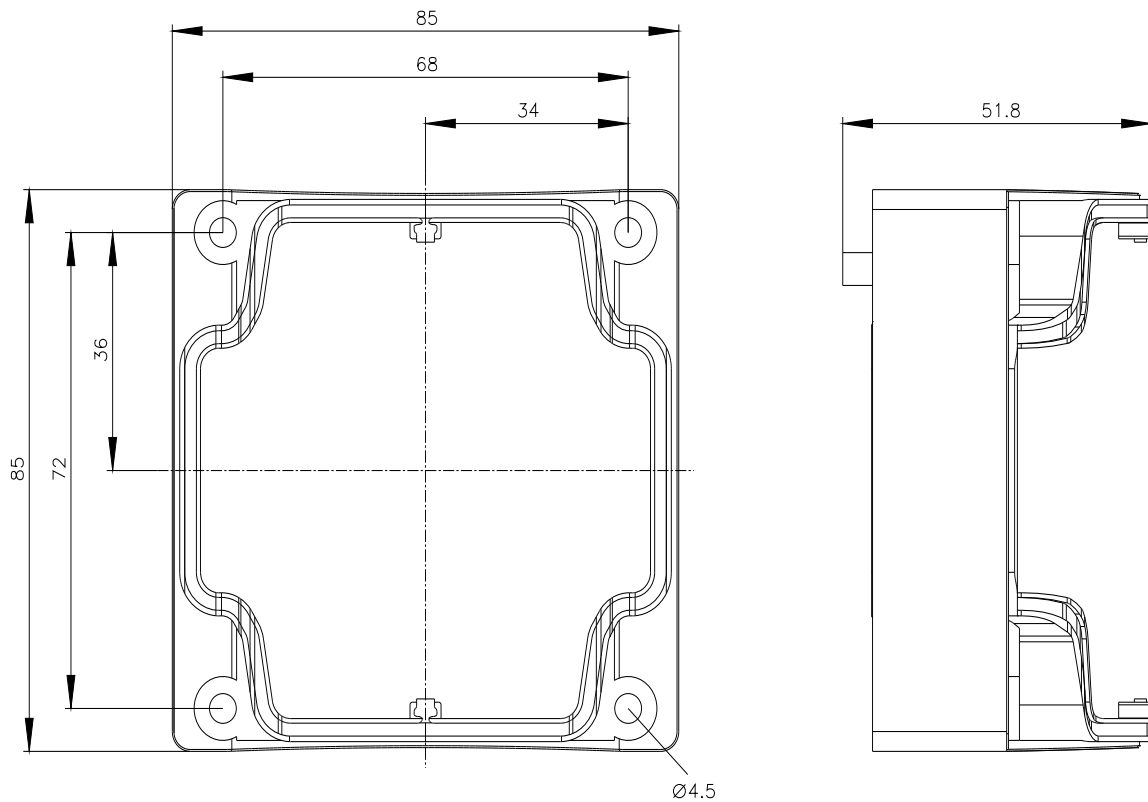

last modified:

4/2/2025