

connecting comb 4-pole (only suitable for signal converter SIRIUS 3RS7 and coupling relay SIRIUS 3RQ3)



product brand name	SIRIUS
product category	Connecting combs
product designation	Connecting comb
design of the product	For linking the same potentials, current carrying capacity for infeed max. 6 A/4-pole
product type designation	3RQ3

General technical data

display version LED	No
product component	
• semi-conductor output	No
flammability class of enclosure material	UL94 V-0
reference code according to IEC 81346-2	X
Substance Prohibitance (day/month/year)	03/25/2015
Net Weight	0.001 kg

Mechanical data

product component plug-in socket	No
----------------------------------	----

Connections/ Terminals

product function removable terminal	No
-------------------------------------	----

Installation/ mounting/ dimensions

height	3.3 mm
width	25 mm
depth	11 mm

Ambient conditions

ambient temperature	
• during operation	-25 ... +60 °C
• during storage	-40 ... +85 °C
• during transport	-40 ... +85 °C

Approvals Certificates

Environment	General Product Approval	EMV	Maritime application
-------------	--------------------------	-----	----------------------

[Environmental Con-
firmations](#)



other

[Confirmation](#)



Further information

Information on the packaging

<https://support.industry.siemens.com/cs/ww/en/view/109813875>

Information for data generation and storage

<https://support.industry.siemens.com/cs/ww/en/view/109995012>

Information- and Downloadcenter (Catalogs, Brochures,...)

<https://www.siemens.com/ic10>

Industry Mall (Online ordering system)

<https://mall.industry.siemens.com/mall/en/en/Catalog/product?mlfb=3RQ3901-0B>

Cax online generator

<https://support.automation.siemens.com/WW/CAXorder/default.aspx?lang=en&mlfb=3RQ3901-0B>

Service&Support (Manuals, Certificates, Characteristics, FAQs,...)

<https://support.industry.siemens.com/cs/ww/en/ps/3RQ3901-0B>

Image database (product images, 2D dimension drawings, 3D models, device circuit diagrams, EPLAN macros, ...)

https://www.automation.siemens.com/bilddb/cax_de.aspx?mlfb=3RQ3901-0B&lang=en

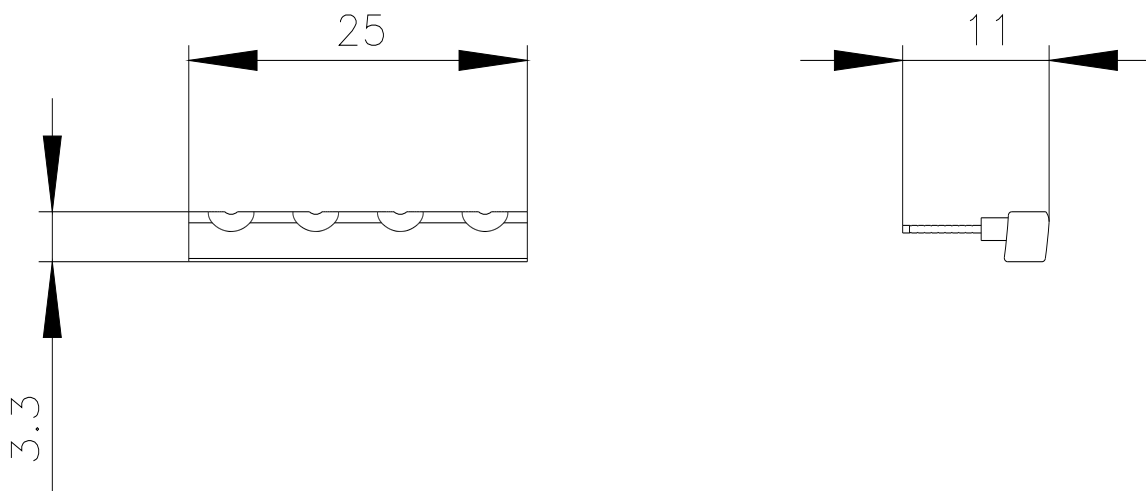

last modified:

4/1/2025 