



busbar adapter 60 mm sys. UL 508 busbar system 60 mm busbar thickness: TT profile UL rating 240-600 V/250 A can be used in feeder circuits IEC rating 690 V/250 A for 3VL circuit breakers with pipe contacting for cable outlet top/bottom adapter length 190 mm adapter width 105 mm for VL150 UL DG frame for VL250 UL FG frame

Model	
product brand name	SENTRON
product designation	Device adapter
design of the product	Accessories
Connections	
type of electrical connection	Tubular contacts
Mechanical Design	
height	190 mm
width of the adapter	105 mm
depth	88 mm
thickness of the busbar	
• minimum	5 mm
busbar center-to-center spacing	60 mm
Net Weight	0.969 kg

Approvals Certificates	
Environment	General Product Approval

[Environmental Con-  
firmations](#)

[Environmental Con-  
firmations](#)



General Product Approval	Test Certificates	Maritime application	other
--------------------------	-------------------	----------------------	-------

[Confirmation](#)



[Miscellaneous](#)



[Confirmation](#)

other
-------



[Miscellaneous](#)

Further information
---------------------

Information on the packaging

<https://support.industry.siemens.com/cs/ww/en/view/109813875>

Information for data generation and storage

<https://support.industry.siemens.com/cs/ww/en/view/109995012>

Information- and Downloadcenter (Catalogs, Brochures,...)

<https://www.siemens.com/lowvoltage/catalogs>

Industry Mall (Online ordering system)

<https://mall.industry.siemens.com/mall/en/en/Catalog/product?mlfb=8US1213-4AQ03>

Service&Support (Manuals, Certificates, Characteristics, FAQs,...)

<https://support.industry.siemens.com/cs/ww/en/ps/8US1213-4AQ03>

Image database (product images, 2D dimension drawings, 3D models, device circuit diagrams, ...)

[https://www.automation.siemens.com/bilddb/cax\\_en.aspx?mlfb=8US1213-4AQ03](https://www.automation.siemens.com/bilddb/cax_en.aspx?mlfb=8US1213-4AQ03)

CAX-Online-Generator

<https://www.siemens.com/cax>

Tender specifications

<https://www.siemens.com/specifications>

Characteristic curves

[https://curves.simaris.siemens.com/curves/<mmp\\_prod\\_noCOMP="HAUPT"></mmp\\_prod\\_no>](https://curves.simaris.siemens.com/curves/<mmp_prod_noCOMP=)

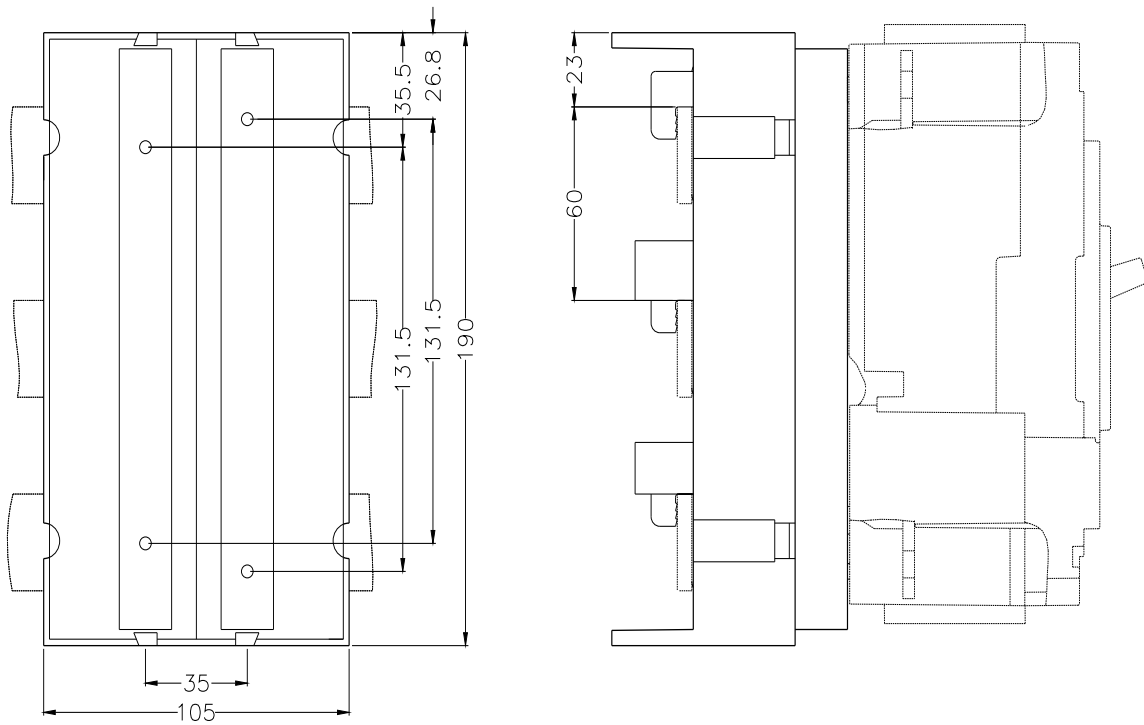

last modified:

4/8/2025

