



Terminal, screw terminal, fuse terminal for G fuse, with illuminated display, 4 mm<sup>2</sup>, black

Model	
product brand name	SETRON
product designation	Terminal blocks
design of the product	fuse terminal
design of fuse holder	swivel
General technical data	
insulation material	PA
terminal contact spacing	6.2 mm
Supply voltage	
operating voltage rated value	630 V
Protection class	
combustibility class according to UL 94	V0
Main circuit	
operational current rated value	6 A
Appearance	
color	black
Product details	
product component required end cover plate	No
Number	
number of terminal levels	1
Connections	
connectable conductor cross-section solid	
• minimum	0.14 mm <sup>2</sup>
• maximum	0.14 mm <sup>2</sup>
connectable conductor cross-section stranded	
• minimum	0.14 mm <sup>2</sup>
• maximum	0.14 mm <sup>2</sup>
connectable conductor cross-section finely stranded	
• with core end processing minimum	4 mm <sup>2</sup>
• with core end processing maximum	4 mm <sup>2</sup>
• without core end processing minimum	0.14 mm <sup>2</sup>
• without core end processing maximum	6 mm <sup>2</sup>
type of connection 1	screw-type terminal
type of connection 2	screw-type terminal
position of the terminal	lateral
Mechanical Design	
height with lowest-profile installation	57.8 mm
depth	74.98 mm

length	58 mm
fastening method	TH35 DIN rail
Net Weight	17 g
material of the insulating body	PA

### Environmental conditions

ambient temperature during operation	
<ul style="list-style-type: none"> <li>• minimum</li> <li>• maximum</li> </ul>	105 °C 105 °C

### Approvals Certificates

Environment	General Product Approval
-------------	--------------------------

[Environmental Con-  
firmations](#)

[Environmental Con-  
firmations](#)



[Confirmation](#)

General Product Ap- proval	other
-------------------------------	-------



[Confirmation](#)



[Miscellaneous](#)

### Further information

- Information on the packaging  
<https://support.industry.siemens.com/cs/ww/en/view/109813875>
- Information for data generation and storage  
<https://support.industry.siemens.com/cs/ww/en/view/109995012>
- Information- and Downloadcenter (Catalogs, Brochures,...)  
<https://www.siemens.com/lowvoltage/catalogs>
- Industry Mall (Online ordering system)  
<https://mall.industry.siemens.com/mall/en/en/Catalog/product?mlfb=8WH1000-1MG88>
- Service&Support (Manuals, Certificates, Characteristics, FAQs,...)  
<https://support.industry.siemens.com/cs/ww/en/ps/8WH1000-1MG88>
- Image database (product images, 2D dimension drawings, 3D models, device circuit diagrams, ...)  
[https://www.automation.siemens.com/bilddb/cax\\_en.aspx?mlfb=8WH1000-1MG88](https://www.automation.siemens.com/bilddb/cax_en.aspx?mlfb=8WH1000-1MG88)
- CAX-Online-Generator  
<https://www.siemens.com/cax>
- Tender specifications  
<https://www.siemens.com/specifications>
- Characteristic curves  
[https://curves.simaris.siemens.com/curves/<mmp\\_prod\\_noCOMP="HAUPT"></mmp\\_prod\\_no>](https://curves.simaris.siemens.com/curves/<mmp_prod_noCOMP=)

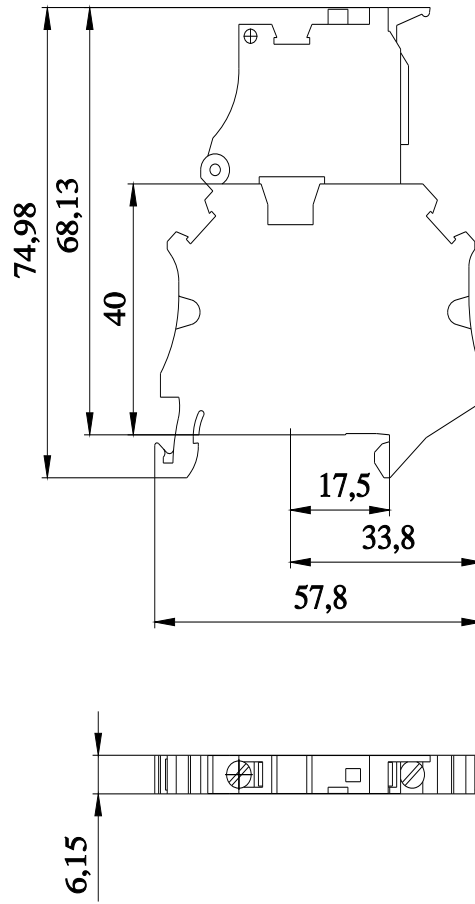

last modified:

5/9/2025 