



connection element with cover, for pipe, base and angle mounting, accessories for signaling columns, with 50 mm diameter

product brand name	SIRIUS
product designation	Connection element
design of the product	for mounting on pipes, floors and angles
General technical data	
reference code according to EN 61346-2	X
Safety related data	
MTTFd	45 662 a
Enclosure	
height	58 mm
width	52 mm
outer diameter of the signal column element	50 mm
material	PA
color	black
fastening method	mounting on pipes
protection class IP	IP54
type of electrical connection	screw terminal
tightening torque with screw-type terminals	0.4 N·m
Ambient conditions	
ambient temperature during operation	-20 ... +50 °C
Approvals Certificates	
General Product Approval	other



[Confirmation](#)



[Confirmation](#)

other

Environment

[Confirmation](#)



[Environmental Confirmations](#)



Further information

Information on the packaging

<https://support.industry.siemens.com/cs/ww/en/view/109813875>

Information for data generation and storage

<https://support.industry.siemens.com/cs/ww/en/view/109995012>

Information- and Downloadcenter (Catalogs, Brochures,...)

<https://www.siemens.com/ic10>

Industry Mall (Online ordering system)

<https://mall.industry.siemens.com/mall/en/en/Catalog/product?mlfb=8WD4208-0AA>

Cax online generator

<https://support.automation.siemens.com/WW/CAXorder/default.aspx?lang=en&mlfb=8WD4208-0AA>

Service&Support (Manuals, Certificates, Characteristics, FAQs,...)

<https://support.industry.siemens.com/cs/ww/en/ps/8WD4208-0AA>

Image database (product images, 2D dimension drawings, 3D models, device circuit diagrams, EPLAN macros, ...)

https://www.automation.siemens.com/bilddb/cax_de.aspx?mlfb=8WD4208-0AA&lang=en

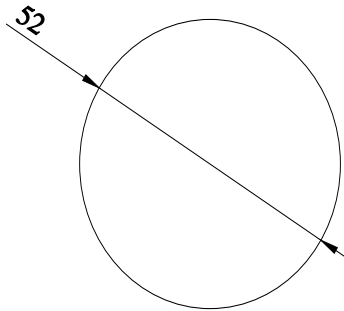
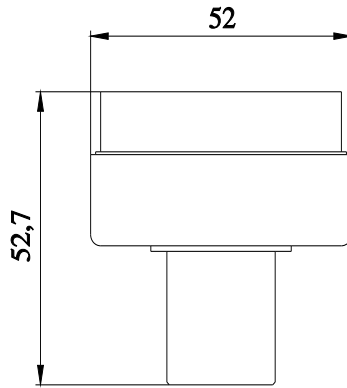

Standard

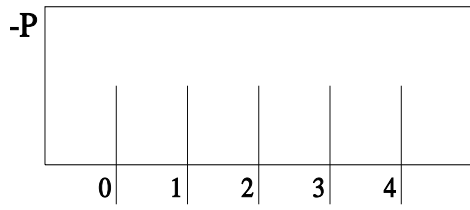

ASI

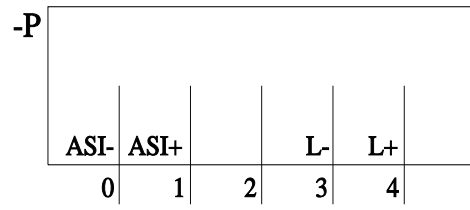

last modified:

4/1/2025