



Solenoid, rectangular large 25 x 88 mm for Magnet switch 3SE66.7-2CA0.
Position: is mounted offset by 90° from the contact block

product brand name	SIRIUS
product designation	Magnetically operated switch
design of the product	coded magnet, rectangular
product type designation	3SE67

General technical data

product feature	90° offset
protection class IP	IP67
Substance Prohibitance (day/month/year)	07/01/2006
Net Weight	0.037 kg
height of the sensor	25 mm
length of the sensor	7 mm
width of the sensor	88 mm

Ambient conditions

ambient temperature during operation	-25 ... +70 °C
--------------------------------------	----------------

Enclosure

material of the enclosure	plastic
---------------------------	---------

Installation/ mounting/ dimensions

fastening method	screw fixing
------------------	--------------

Approvals Certificates

General Product Approval	EMV	other
--------------------------	-----	-------



[Confirmation](#)

other	Dangerous goods	Environment
-------	-----------------	-------------

[Confirmation](#)



[Transport Information](#)

[Environmental Confirmations](#)

Further information

Information on the packaging
<https://support.industry.siemens.com/cs/ww/en/view/109813875>
 Information for data generation and storage
<https://support.industry.siemens.com/cs/ww/en/view/109995012>
 Information- and Downloadcenter (Catalogs, Brochures,...)
<https://www.siemens.com/ic10>

Industry Mall (Online ordering system)

<https://mall.industry.siemens.com/mall/en/en/Catalog/product?mlfb=3SE6724-2CA>

Cax online generator

<https://support.automation.siemens.com/WW/CAXorder/default.aspx?lang=en&mlfb=3SE6724-2CA>

Service&Support (Manuals, Certificates, Characteristics, FAQs,...)

<https://support.industry.siemens.com/cs/ww/en/ps/3SE6724-2CA>

Image database (product images, 2D dimension drawings, 3D models, device circuit diagrams, EPLAN macros, ...)

https://www.automation.siemens.com/bilddb/cax_de.aspx?mlfb=3SE6724-2CA&lang=en

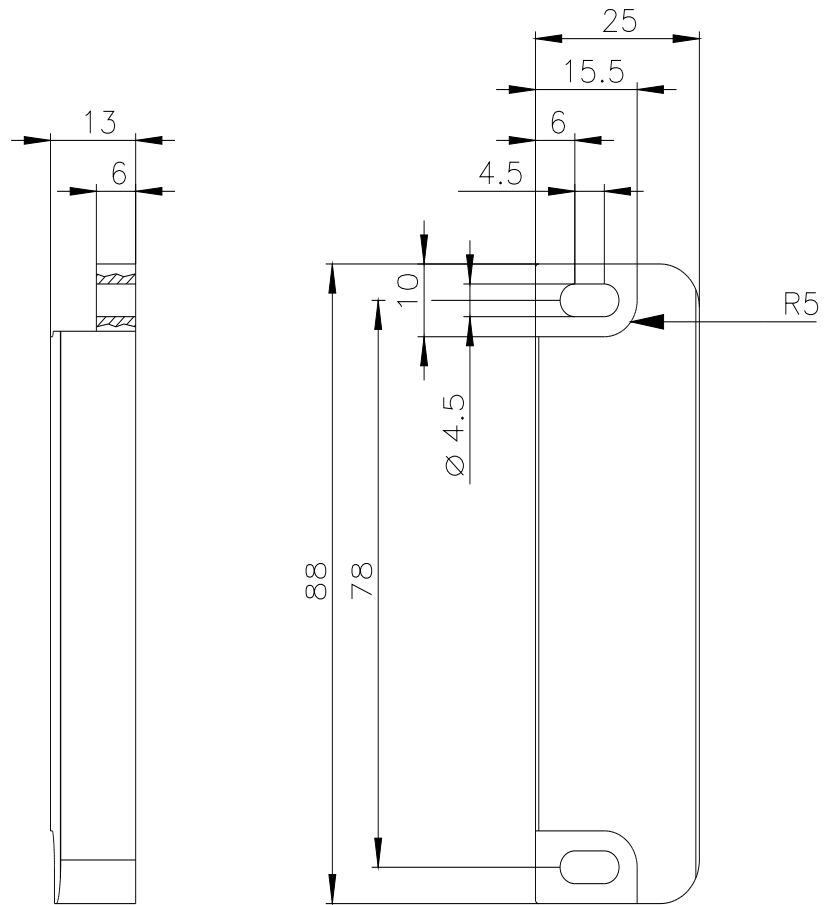

last modified:

5/8/2025 