

Prism terminal double 2x 70 - 120 mm<sup>2</sup>, for size NH2 with screw terminal, accessory for fuse switch disconnecter 3NP1 Contains 3 terminals

| Model                  |  |
|------------------------|--|
| product brand name     | SENTRON  |
| product designation    | Prism terminal, double 2x 70 - 120 mm <sup>2</sup> |
| design of the product  | accessories for 3NP1 fuse switch disconnectors     |
| suitability for use    | for 3NP1, 3-pole, NH2, with flat connector         |
| Accessories            |  |
| accessories            | for size NH2 with screw terminals                  |
| Mechanical Design      |  |
| Net Weight             | 747 g  |
| Approvals Certificates |  |
| Environment            | General Product Approval                           |

[Environmental Con-  
firmations](#)

[Environmental Con-  
firmations](#)

[Miscellaneous](#)



| Test Certificates | Maritime application | other |
|-------------------|----------------------|-------|
|-------------------|----------------------|-------|

[Type Test Certi-  
ficates/Test Report](#)



[Confirmation](#)



### Further information

Information on the packaging

<https://support.industry.siemens.com/cs/ww/en/view/109813875>

Information for data generation and storage

<https://support.industry.siemens.com/cs/ww/en/view/109995012>

Information- and Downloadcenter (Catalogs, Brochures,...)

<https://www.siemens.com/lowvoltage/catalogs>

Industry Mall (Online ordering system)

<https://mall.industry.siemens.com/mall/en/en/Catalog/product?mlfb=3NP1953-1BB20>

Service&Support (Manuals, Certificates, Characteristics, FAQs,...)

<https://support.industry.siemens.com/cs/ww/en/ps/3NP1953-1BB20>

Image database (product images, 2D dimension drawings, 3D models, device circuit diagrams, ...)

[https://www.automation.siemens.com/bilddb/cax\\_en.aspx?mlfb=3NP1953-1BB20](https://www.automation.siemens.com/bilddb/cax_en.aspx?mlfb=3NP1953-1BB20)

CAX-Online-Generator

<https://www.siemens.com/cax>

Tender specifications

<https://www.siemens.com/specifications>

Characteristic curves

[https://curves.simaris.siemens.com/curves/<mmp\\_prod\\_noCOMP='HAUPT'></mmp\\_prod\\_no>](https://curves.simaris.siemens.com/curves/<mmp_prod_noCOMP='HAUPT'></mmp_prod_no>)

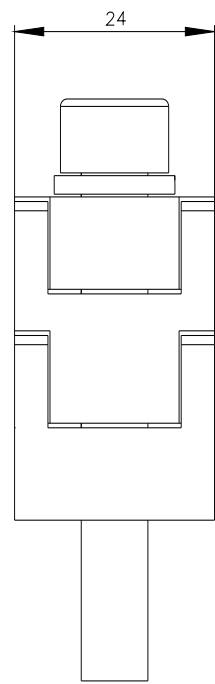
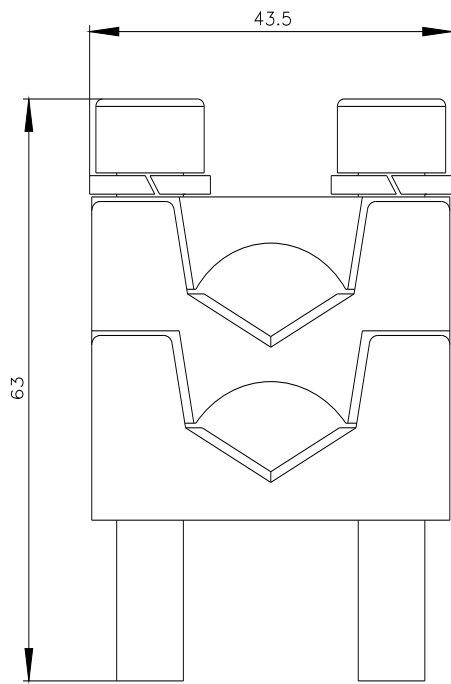

---

last modified:

4/12/2025 

