



Door-coupling rotary operating mechanism red / yellow 48x48 mm, Front plate mounting Central hole mounting 22.5mm with coupling part with shaft 300 mm long, 6x6 mm, accessories for load disconnecter 3LD3

Model	
product designation	Door mounted rotary operator
design of the product	accessories for 3LD3 switch disconnectors
degree of protection NEMA rating	1. 3R. 4X. 12
color of the actuating element	red / yellow
product feature interlock	No
product feature can be locked into OFF position	Yes
length of the extension shaft	300 mm
Net Weight	205 g

Approvals Certificates	
Environment	General Product Approval

[Environmental Confirmations](#)

[Environmental Confirmations](#)



[Confirmation](#)



General Product Approval	other
--------------------------	-------



[Confirmation](#)



### Further information

Information on the packaging

<https://support.industry.siemens.com/cs/ww/en/view/109813875>

Information for data generation and storage

<https://support.industry.siemens.com/cs/ww/en/view/109995012>

Information- and Downloadcenter (Catalogs, Brochures,...)

<https://www.siemens.com/lowvoltage/catalogs>

Industry Mall (Online ordering system)

<https://mall.industry.siemens.com/mall/en/en/Catalog/product?mlfb=3LD9343-5CA>

Service&Support (Manuals, Certificates, Characteristics, FAQs,...)

<https://support.industry.siemens.com/cs/ww/en/ps/3LD9343-5CA>

Image database (product images, 2D dimension drawings, 3D models, device circuit diagrams, ...)

[https://www.automation.siemens.com/bilddb/cax\\_en.aspx?mlfb=3LD9343-5CA](https://www.automation.siemens.com/bilddb/cax_en.aspx?mlfb=3LD9343-5CA)

CAX-Online-Generator

<https://www.siemens.com/cax>

Tender specifications

<https://www.siemens.com/specifications>

Characteristic curves

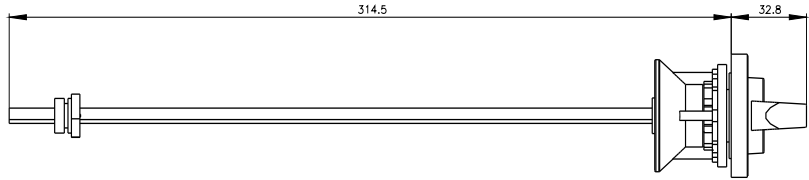
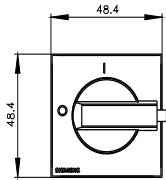

---

last modified:

5/26/2025 