



PE-through terminal, Floor installation, accessory for Load disconnecter 3LD3

| Model | |
|--|---|
| product brand name | SENTRON |
| product designation | PE through-type terminal |
| design of the product | accessories for 3LD3 switch disconnectors |
| Accessories | |
| accessories | floor mounting |
| AWG number as coded connectable conductor cross section | |
| • minimum | 14 |
| • maximum | 6 |
| tightening torque with screw-type terminals | |
| • minimum | 3 N·m |
| • maximum | 3 N·m |
| type of connectable conductor cross-sections for main contacts | |
| • finely stranded with core end processing | 1x (2.515 mm ²) |
| • solid or stranded | 1x (2.5 ... 16 mm ²) |
| Mechanical Design | |
| Net Weight | 40 g |
| Approvals Certificates | |
| Environment | General Product Approval |

[Environmental Confirmations](#)

[Environmental Confirmations](#)



[Confirmation](#)



other



[Confirmation](#)

Further information

- Information on the packaging
<https://support.industry.siemens.com/cs/ww/en/view/109813875>
- Information for data generation and storage
<https://support.industry.siemens.com/cs/ww/en/view/109995012>
- Information- and Downloadcenter (Catalogs, Brochures,...)
<https://www.siemens.com/lowvoltage/catalogs>

Industry Mall (Online ordering system)

<https://mall.industry.siemens.com/mall/en/en/Catalog/product?mlfb=3LD9340-3C>

Service&Support (Manuals, Certificates, Characteristics, FAQs,...)

<https://support.industry.siemens.com/cs/ww/en/ps/3LD9340-3C>

Image database (product images, 2D dimension drawings, 3D models, device circuit diagrams, ...)

https://www.automation.siemens.com/bilddb/cax_en.aspx?mlfb=3LD9340-3C

CAX-Online-Generator

<https://www.siemens.com/cax>

Tender specifications

<https://www.siemens.com/specifications>

Characteristic curves

https://curves.simarisiemens.com/curves/<mmp_prod_noCOMP='HAUPT'></mmp_prod_no>

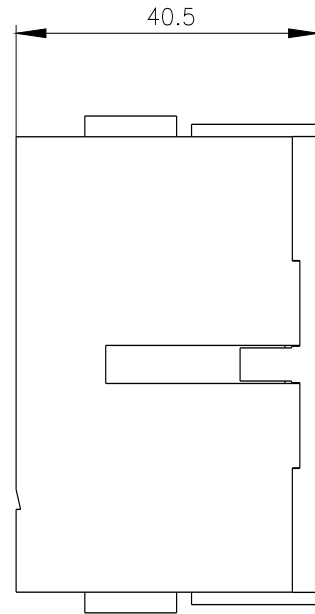
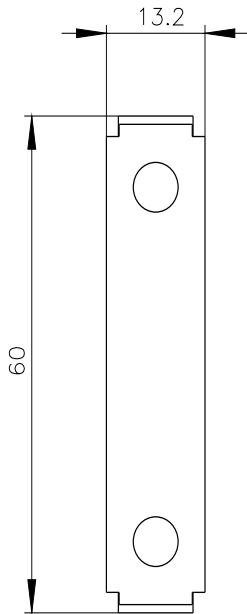

last modified:

4/12/2025 

