



N-through terminal, Front installation, accessory for Load disconnecter 3LD3

Model	
product brand name	SETRON
product designation	N through-type terminal
design of the product	accessories for 3LD3 switch disconnectors
Accessories	
accessories	front mounting
AWG number as coded connectable conductor cross section	
• minimum	14
• maximum	6
tightening torque with screw-type terminals	
• minimum	3 N·m
• maximum	3 N·m
type of connectable conductor cross-sections for main contacts	
• finely stranded with core end processing	1x (2.515 mm ²)
• solid or stranded	1x (2.5 ... 16 mm ²)
Mechanical Design	
Net Weight	40 g
Approvals Certificates	
Environment	General Product Approval

[Environmental Confirmations](#)

[Environmental Confirmations](#)



[Confirmation](#)



other

[Confirmation](#)



Further information

- Information on the packaging
<https://support.industry.siemens.com/cs/ww/en/view/109813875>
- Information for data generation and storage
<https://support.industry.siemens.com/cs/ww/en/view/109995012>
- Information- and Downloadcenter (Catalogs, Brochures,...)
<https://www.siemens.com/lowvoltage/catalogs>

Industry Mall (Online ordering system)

<https://mall.industry.siemens.com/mall/en/en/Catalog/product?mlfb=3LD9340-2B>

Service&Support (Manuals, Certificates, Characteristics, FAQs,...)

<https://support.industry.siemens.com/cs/ww/en/ps/3LD9340-2B>

Image database (product images, 2D dimension drawings, 3D models, device circuit diagrams, ...)

https://www.automation.siemens.com/bilddb/cax_en.aspx?mlfb=3LD9340-2B

CAX-Online-Generator

<https://www.siemens.com/cax>

Tender specifications

<https://www.siemens.com/specifications>

Characteristic curves

[https://curves.simaris.siemens.com/curves/<mmp_prod_noCOMP="HAUPT"></mmp_prod_no>](https://curves.simaris.siemens.com/curves/<mmp_prod_noCOMP=)

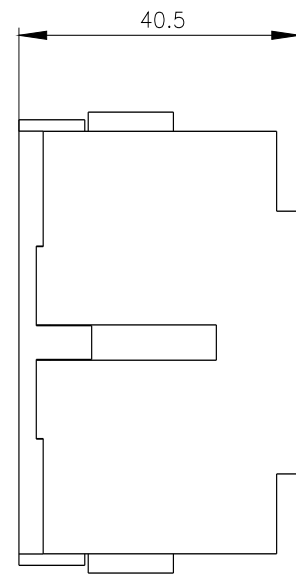
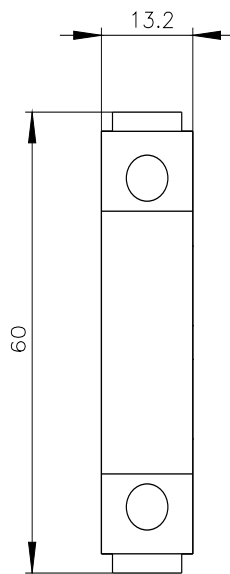

last modified:

4/12/2025 

