



N switching contact, Floor installation accessory for Load disconnecter 3LD3

Model	
product brand name	SETRON
product designation	N switching contact, leading
design of the product	accessories for 3LD3 switch disconnectors
Accessories	
accessories	floor mounting
AWG number as coded connectable conductor cross section	
<ul style="list-style-type: none"> • minimum • maximum 	14 6
tightening torque with screw-type terminals	
<ul style="list-style-type: none"> • minimum • maximum 	3 N·m 3 N·m
type of connectable conductor cross-sections for main contacts	
<ul style="list-style-type: none"> • finely stranded with core end processing • solid or stranded 	1x (2.515 mm ²) 1x (2.5 ... 16 mm ²)
Mechanical Design	
Net Weight	43 g
Approvals Certificates	
Environment	General Product Approval

[Environmental Con-
firmations](#)

[Environmental Con-
firmations](#)



[Confirmation](#)



other

[Confirmation](#)



Further information

- Information on the packaging
<https://support.industry.siemens.com/cs/ww/en/view/109813875>
- Information for data generation and storage
<https://support.industry.siemens.com/cs/ww/en/view/109995012>
- Information- and Downloadcenter (Catalogs, Brochures,...)
<https://www.siemens.com/lowvoltage/catalogs>

Industry Mall (Online ordering system)

<https://mall.industry.siemens.com/mall/en/en/Catalog/product?mlfb=3LD9340-0C>

Service&Support (Manuals, Certificates, Characteristics, FAQs,...)

<https://support.industry.siemens.com/cs/ww/en/ps/3LD9340-0C>

Image database (product images, 2D dimension drawings, 3D models, device circuit diagrams, ...)

https://www.automation.siemens.com/bilddb/cax_en.aspx?mlfb=3LD9340-0C

CAX-Online-Generator

<https://www.siemens.com/cax>

Tender specifications

<https://www.siemens.com/specifications>

Characteristic curves

https://curves.simarisiemens.com/curves/<mmp_prod_noCOMP='HAUPT'></mmp_prod_no>

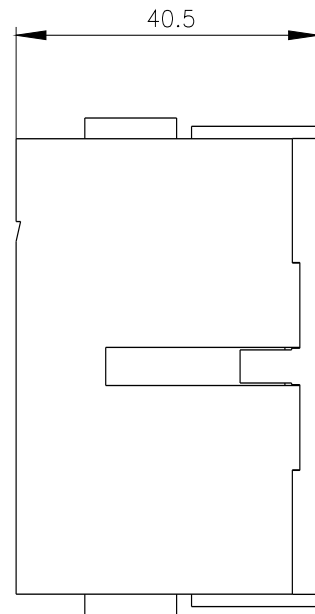
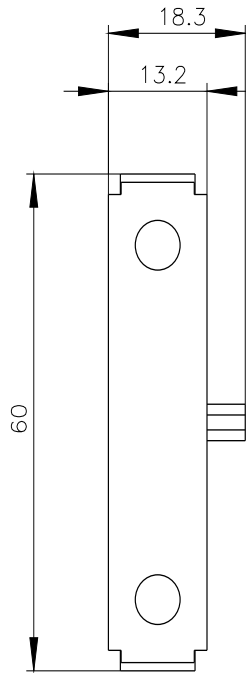

last modified:

4/12/2025 

