



Main miniature circuit breaker (SHU), 3x 1-pole, E 63A, 230/400 V Mounting on 40 mm busbars

Model	
product brand name	SENTRON
product designation	Miniature circuit breaker
design of the product	Main miniature circuit breaker
design of the locking device	Locking slide with lock, additional wire seal, cable ties and Antilux
General technical data	
number of poles	3
design of pole	3P
tripping characteristic class	E
mechanical service life (operating cycles) typical	20 000
overvoltage category	4
degree of pollution	3
Voltage	
insulation voltage (Ui) rated value	690 V
surge voltage resistance rated value	6 kV
supply voltage with single-phase operation at AC rated value	230 V
<ul style="list-style-type: none"> ● operational current <ul style="list-style-type: none"> — at 30 °C rated value — at 40 °C rated value — at 50 °C rated value — at 55 °C rated value ● operational current at AC rated value 	63 A 59.85 A 56.7 A 55.125 A 63 A
Supply voltage	
supply voltage at AC	400 V
operating voltage rated value <ul style="list-style-type: none"> ● minimum ● maximum 	110 V 440 V
supply voltage frequency rated value	50 Hz
Protection class	
protection class IP	IP40, with connected conductors
Breaking Capacity	
switching capacity current <ul style="list-style-type: none"> ● rated value ● according to EN 60898 rated value 	25 kA 25 kA
Dissipation	
power loss [W] for rated value of the current at AC in hot operating state per pole	9.7 W

suitability for operation	Residential buildings/infrastructure
---------------------------	--------------------------------------

Product details

product component	
<ul style="list-style-type: none"> outgoing feeder via spring-loaded terminal infeed at box terminal 	Yes
product feature properties for main switches in accordance with EN 60204-1	Yes
product feature sealable	Yes

Display and operation

display version for switch position indicator	OFF = green, ON = red
---	-----------------------

Connections

connectable conductor cross-section of spring-loaded terminal finely stranded with core end processing	
<ul style="list-style-type: none"> minimum maximum 	2.5 mm ² 16 mm ²
connectable conductor cross-section of the box terminal	
<ul style="list-style-type: none"> solid minimum solid maximum stranded minimum stranded maximum 	2.5 mm ² 50 mm ² 2.5 mm ² 50 mm ²
position of power supply cord	Stipulated by installation in the lower section of the meter panel

Mechanical Design

height	151.3 mm
depth	89.5 mm
depth of the enclosure	76.3 mm
number of modular width units	4.5
fastening method	Busbar
fastening method other	on 40-mm busbar system in compliance with DIN 43870 Part 2
Net Weight	1.305 kg

Environmental conditions

shock resistance	30 g, at least 3 impacts, impact duration 11 ms
vibration resistance according to IEC 60068-2-6	2 g, 20 frequency cycles 5 to 150 to 15 Hz
ambient temperature during operation	
<ul style="list-style-type: none"> minimum maximum 	-25 °C 55 °C
ambient temperature during storage	
<ul style="list-style-type: none"> minimum maximum 	-40 °C 70 °C

Approvals Certificates

Environment	General Product Approval	other
-------------	--------------------------	-------

[Environmental Con-
firmations](#)

[Environmental Con-
firmations](#)



other

[Confirmation](#)

Further information

Information on the packaging
<https://support.industry.siemens.com/cs/ww/en/view/109813875>
 Information for data generation and storage
<https://support.industry.siemens.com/cs/ww/en/view/109995012>
 Information- and Downloadcenter (Catalogs, Brochures,...)
<https://www.siemens.com/lowvoltage/catalogs>
 Industry Mall (Online ordering system)

<https://mall.industry.siemens.com/mall/en/en/Catalog/product?mlfb=5SP3863-2>

Service&Support (Manuals, Certificates, Characteristics, FAQs,...)

<https://support.industry.siemens.com/cs/ww/en/ps/5SP3863-2>

Image database (product images, 2D dimension drawings, 3D models, device circuit diagrams, ...)

https://www.automation.siemens.com/bilddb/cax_en.aspx?mlfb=5SP3863-2

CAX-Online-Generator

<https://www.siemens.com/cax>

Tender specifications

<https://www.siemens.com/specifications>

Characteristic curves

[https://curves.simaris.siemens.com/curves/<mmp_prod_noCOMP="HAUPT"></mmp_prod_no>](https://curves.simaris.siemens.com/curves/<mmp_prod_noCOMP=)

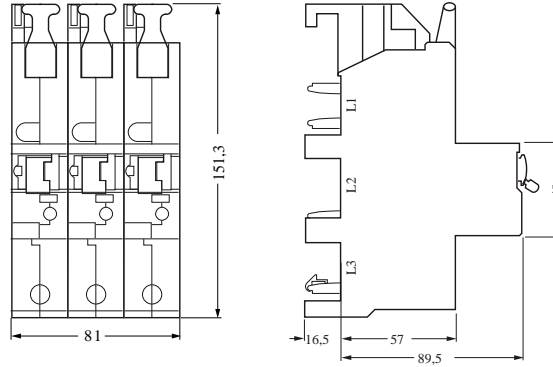

last modified:

7/22/2025

