



two-hand operation console for command devices, 22 mm, round, enclosure material plastic, enclosure top part gray, 3 holes for command points, 8 additional preset breaking points for 22 mm command devices, without equipment, with cable cut-outs for metric screw connections



product brand name	SIRIUS ACT
product designation	Two-hand operation console
product type designation	3SU1
Enclosure	
design of the housing	Two-hand operating console without standard equipment
material of the enclosure	plastic
number of command points	3
color of the enclosure top part	grey
delivery state	
• as a kit	No
• pre-wired on strip terminal	No
fastening method of the enclosure	Horizontal
Actuator	
design of the actuating element	Unequipped
principle of operation of the actuating element	without
product feature	
• lockout	No
• staggered switching	No
number of contact modules	0
General technical data	
product function	
• positive opening	No
• EMERGENCY OFF function	No
• EMERGENCY STOP function	No
product component stand/pedestal	No
protection class IP	IP66
degree of protection NEMA rating	1, 4X, 12K, indoor use only, 13
shock resistance according to IEC 60068-2-27	sinusoidal half-wave 15 g / 11 ms
vibration resistance according to IEC 60068-2-6	10 ... 500 Hz: 5 g
reference code according to IEC 81346-2	U
Substance Prohibitance (day/month/year)	10/01/2014
Net Weight	2.103 kg
Auxiliary circuit	
number of NC contacts for auxiliary contacts	0
number of NO contacts for auxiliary contacts	0
Connections/ Terminals	

type of electrical connection on enclosure	Cable routing at the rear 2 x M25
---	-----------------------------------

Ambient conditions

ambient temperature	
<ul style="list-style-type: none"> during operation during storage 	-25 ... +70 °C -40 ... +80 °C
environmental category during operation according to IEC 60721	3M6, 3S2, 3B2, 3C3, 3K6 (with relative air humidity of 10 ... 95%, no condensation in operation permitted for all devices behind front panel)

Installation/ mounting/ dimensions

height	185.3 mm
width	469.1 mm
depth	137.4 mm

Accessories

number of backing plates	0
---------------------------------	---

Approvals Certificates

Environmental Product Declaration	
<ul style="list-style-type: none"> global warming potential [CO2 eq] / during manufacturing global warming potential [CO2 eq] / during operation global warming potential [CO2 eq] / after end of life global warming potential [CO2 eq] / total 	0.566 kg 0.235 kg -0.0145 kg 0.787 kg

Environment

General Product Approval

[Environmental Confirmations](#)



General Product Approval

Test Certificates

Maritime application



[Type Test Certificates/Test Report](#)

[Special Test Certificate](#)



Maritime application

other



[Confirmation](#)



Further information

Information on the packaging

<https://support.industry.siemens.com/cs/ww/en/view/109813875>

Information for data generation and storage

<https://support.industry.siemens.com/cs/ww/en/view/109995012>

Information- and Downloadcenter (Catalogs, Brochures,...)

<https://www.siemens.com/ic10>

Industry Mall (Online ordering system)

<https://mall.industry.siemens.com/mall/en/en/Catalog/product?mlfb=3SU1803-3AA00-0AA1>

Cax online generator

<https://support.automation.siemens.com/WW/CAXorder/default.aspx?lang=en&mlfb=3SU1803-3AA00-0AA1>

Service&Support (Manuals, Certificates, Characteristics, FAQs,...)

<https://support.industry.siemens.com/cs/ww/en/ps/3SU1803-3AA00-0AA1>

Image database (product images, 2D dimension drawings, 3D models, device circuit diagrams, EPLAN macros, ...)

https://www.automation.siemens.com/bilddb/cax_de.aspx?mlfb=3SU1803-3AA00-0AA1&lang=en

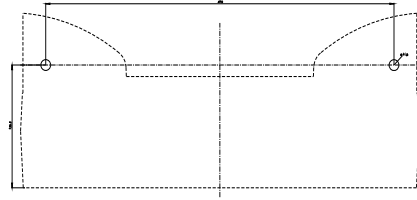
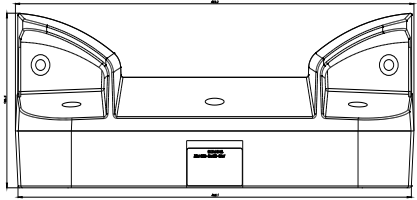

last modified:

5/5/2026 