



accessories for 3KD size 1/2, 3KF size 1, 3KC0 size 1/2, auxiliary switch module for max. 2 auxiliary switches leading, with test function

Model	
product brand name	SENTRON
product designation	Accessories for switch disconnectors
design of the product	Auxiliary switch module
Auxiliary circuit	
number of CO contacts of auxiliary contacts instantaneous contact	0
number of NC contacts for auxiliary contacts instantaneous contact	0
number of NO contacts for auxiliary contacts instantaneous contact	0
Suitability	
suitability for use	For 3KD sizes 1 and 2
Product details	
product description	For max. 2 auxiliary switches, leading, with test function
Mechanical Design	
height	84 mm
width	27.65 mm
depth	60.5 mm
fastening method	Side mounting
Net Weight	141 g
Approvals Certificates	
Environment	General Product Approval

[Environmental Con-  
firmations](#)

[Environmental Con-  
firmations](#)



[Miscellaneous](#)



General Product Approval

Test Certificates

Maritime application

other

[Confirmation](#)



[Type Test Certifi-  
cates/Test Report](#)



[Confirmation](#)

other



Miscellaneous

#### Further information

##### Information on the packaging

<https://support.industry.siemens.com/cs/ww/en/view/109813875>

##### Information for data generation and storage

<https://support.industry.siemens.com/cs/ww/en/view/109995012>

##### Information- and Downloadcenter (Catalogs, Brochures,...)

<https://www.siemens.com/lowvoltage/catalogs>

##### Industry Mall (Online ordering system)

<https://mall.industry.siemens.com/mall/en/en/Catalog/product?mlfb=3KD9103-7>

##### Service&Support (Manuals, Certificates, Characteristics, FAQs,...)

<https://support.industry.siemens.com/cs/ww/en/ps/3KD9103-7>

##### Image database (product images, 2D dimension drawings, 3D models, device circuit diagrams, ...)

[https://www.automation.siemens.com/bilddb/cax\\_en.aspx?mlfb=3KD9103-7](https://www.automation.siemens.com/bilddb/cax_en.aspx?mlfb=3KD9103-7)

##### CAX-Online-Generator

<https://www.siemens.com/cax>

##### Tender specifications

<https://www.siemens.com/specifications>

##### Characteristic curves

[https://curves.simaris.siemens.com/curves/<mmp\\_prod\\_noCOMP="HAUPT"></mmp\\_prod\\_no>](https://curves.simaris.siemens.com/curves/<mmp_prod_noCOMP=)

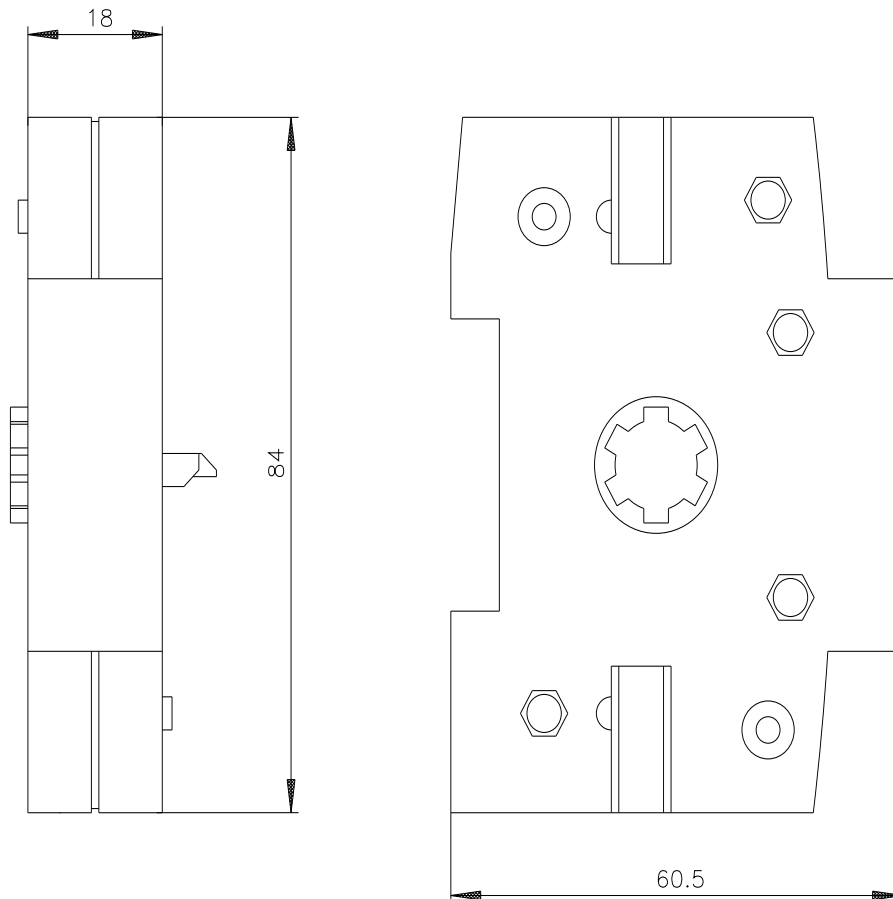

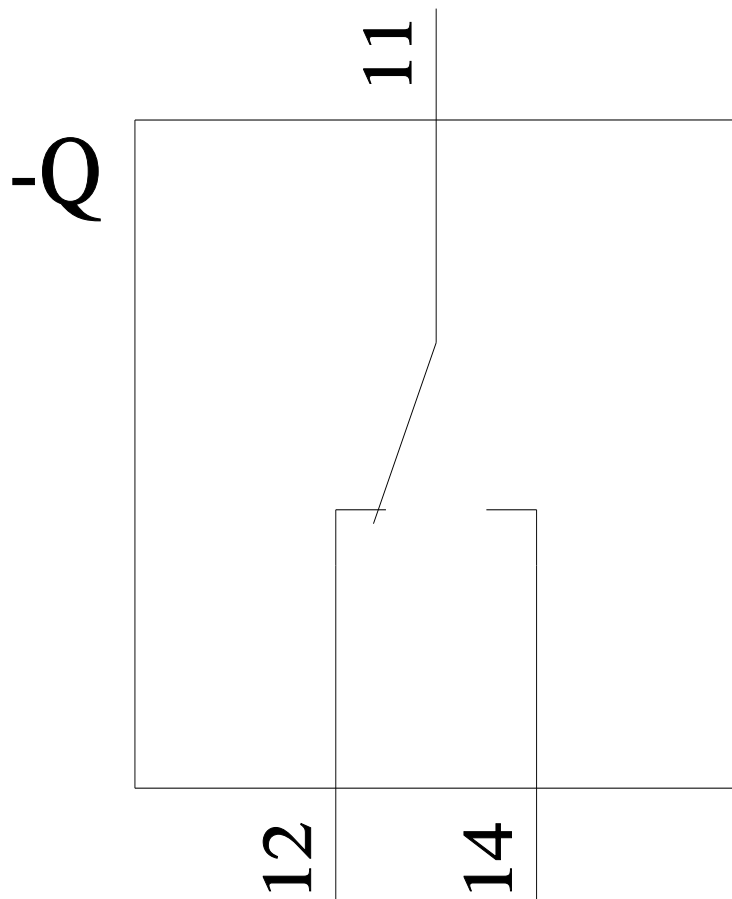

**-CR**

