

17.4mm × 42mm Ceramic Cartridge Power Fuse - Stud Mount

multicomp PRO

**RoHS
Compliant**



Application

Ideal for use in electric vehicles charging protection boards.

Specifications

Current Rating	: 50A - 180A
Voltage Rating	: 240V
Interrupting Current rating	: 160,000 amperes at 240V AC 50,000 amperes at 150V DC
Minimum Breaking Capacity	: 8.0xI _n A @ 240V AC 8.0xI _n A @ 150V DC
Insulation	: After the IR test, the insulation resistance is not less than 0.05MΩ at 500V DC voltage
Fuse Body Material	: Ceramic
Fuse Caps Material	: Tin Plated Copper Alloy
Termination Material	: Tin Plated Copper
Operating Temperature	: -55°C to 125°C
UL Approved	

Part Number	Ampere Rating (A)	Voltage Rating (V)	Nominal Cold Resistance (Ohms)	Watts Loss 100% In (W)	Clearing at 240V I ² t (A ² sec.)
MP001918	50A	240V	0.00183	8.8	2463
MP001919	60A		0.00156	11	3574
MP001920	70A		0.00117	12.5	4047
MP001921	80A		0.00098	13.7	5447
MP001922	100A		0.00072	16.2	8352
MP001923	125A		0.0006	22	10077
MP001924	150A		0.00049	25	15100
MP001925	180A		0.00038	25	17268

Mechanical Dimensions

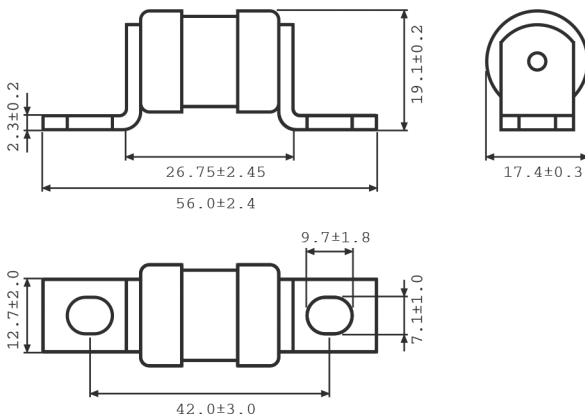

Dimensions : Millimetres

Newark.com/multicomp-pro
Farnell.com/multicomp-pro
sg.element14.com/b/multicomp-pro

multicomp PRO

17.4mm × 42mm Ceramic Cartridge Power Fuse - Stud Mount



Temperature Re-rating curve

Chart Showing Effect of Ambient Temperature on Current – Carrying Capacity

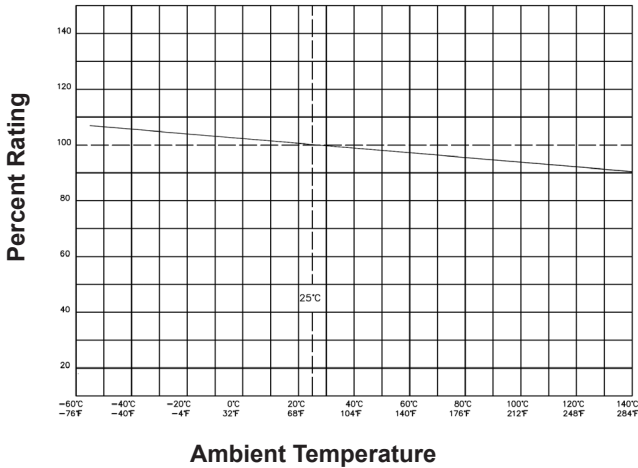

Average Melting It Curves

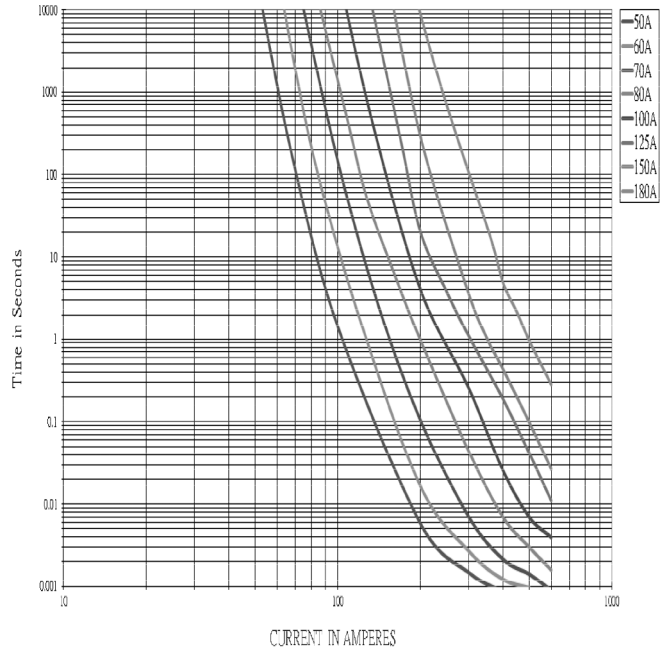

Part Number Table

Description	Part Number
Ceramic Cartridge Power Fuse, Ø17.4mm × 42mm, 50A, 240V AC, Stud Mount	MP001918
Ceramic Cartridge Power Fuse, Ø17.4mm × 42mm, 60A, 240V AC, Stud Mount	MP001919
Ceramic Cartridge Power Fuse, Ø17.4mm × 42mm, 70A, 240V AC, Stud Mount	MP001920
Ceramic Cartridge Power Fuse, Ø17.4mm × 42mm, 80A, 240V AC, Stud Mount	MP001921
Ceramic Cartridge Power Fuse, Ø17.4mm × 42mm, 100A, 240V AC, Stud Mount	MP001922
Ceramic Cartridge Power Fuse, Ø17.4mm × 42mm, 125A, 240V AC, Stud Mount	MP001923
Ceramic Cartridge Power Fuse, Ø17.4mm × 42mm, 150A, 240V AC, Stud Mount	MP001924
Ceramic Cartridge Power Fuse, Ø17.4mm × 42mm, 180A, 240V AC, Stud Mount	MP001925

Important Notice : This data sheet and its contents (the "Information") belong to the members of the AVNET group of companies (the "Group") or are licensed to it. No licence is granted for the use of it other than for information purposes in connection with the products to which it relates. No licence of any intellectual property rights is granted. The Information is subject to change without notice and replaces all data sheets previously supplied. The Information supplied is believed to be accurate but the Group assumes no responsibility for its accuracy or completeness, any error in or omission from it or for any use made of it. Users of this data sheet should check for themselves the Information and the suitability of the products for their purpose and not make any assumptions based on information included or omitted. Liability for loss or damage resulting from any reliance on the Information or use of it (including liability resulting from negligence or where the Group was aware of the possibility of such loss or damage arising) is excluded. This will not operate to limit or restrict the Group's liability for death or personal injury resulting from its negligence. Multicomp Pro is the registered trademark of Premier Farnell Limited 2019.

