

## PCB Terminal Blocks and Pluggable Connectors for Power Electronics

More Power on Your PCB

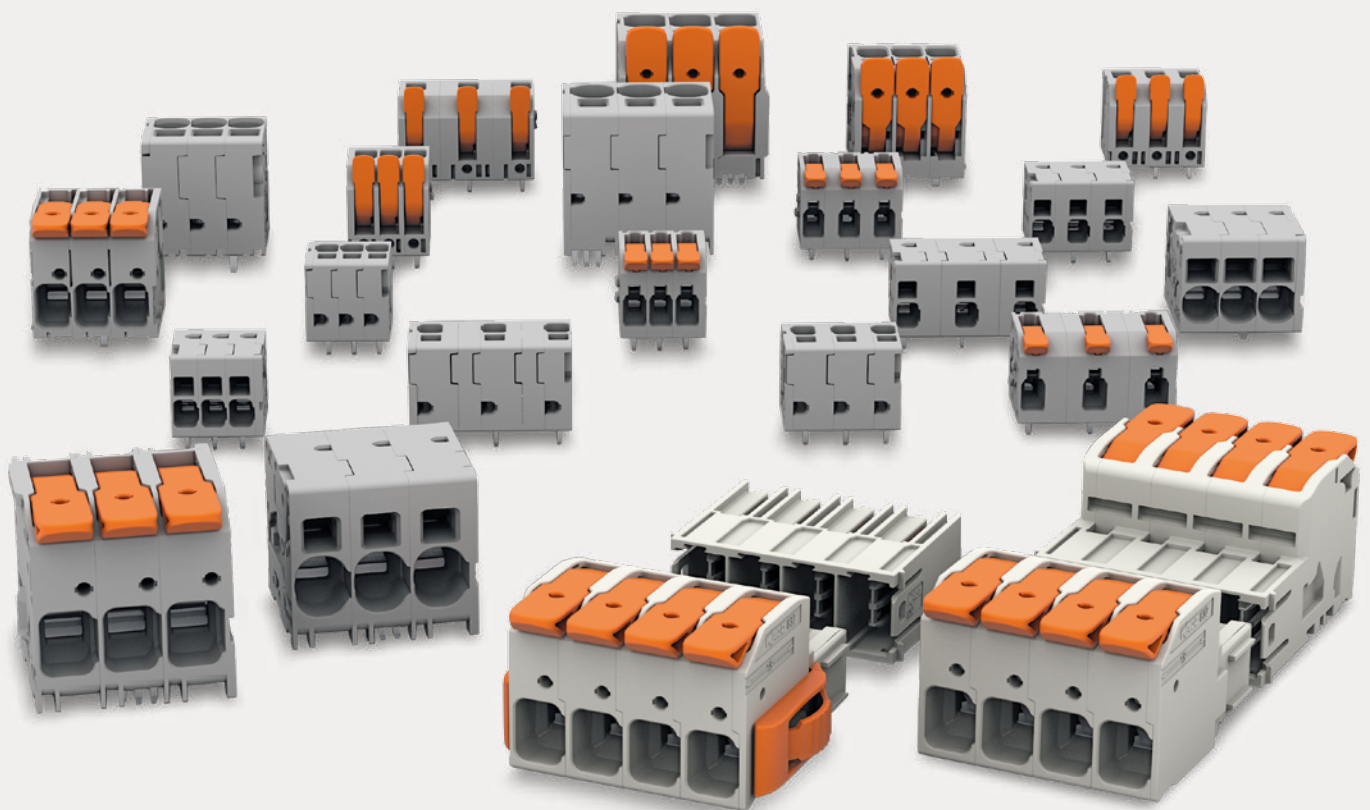

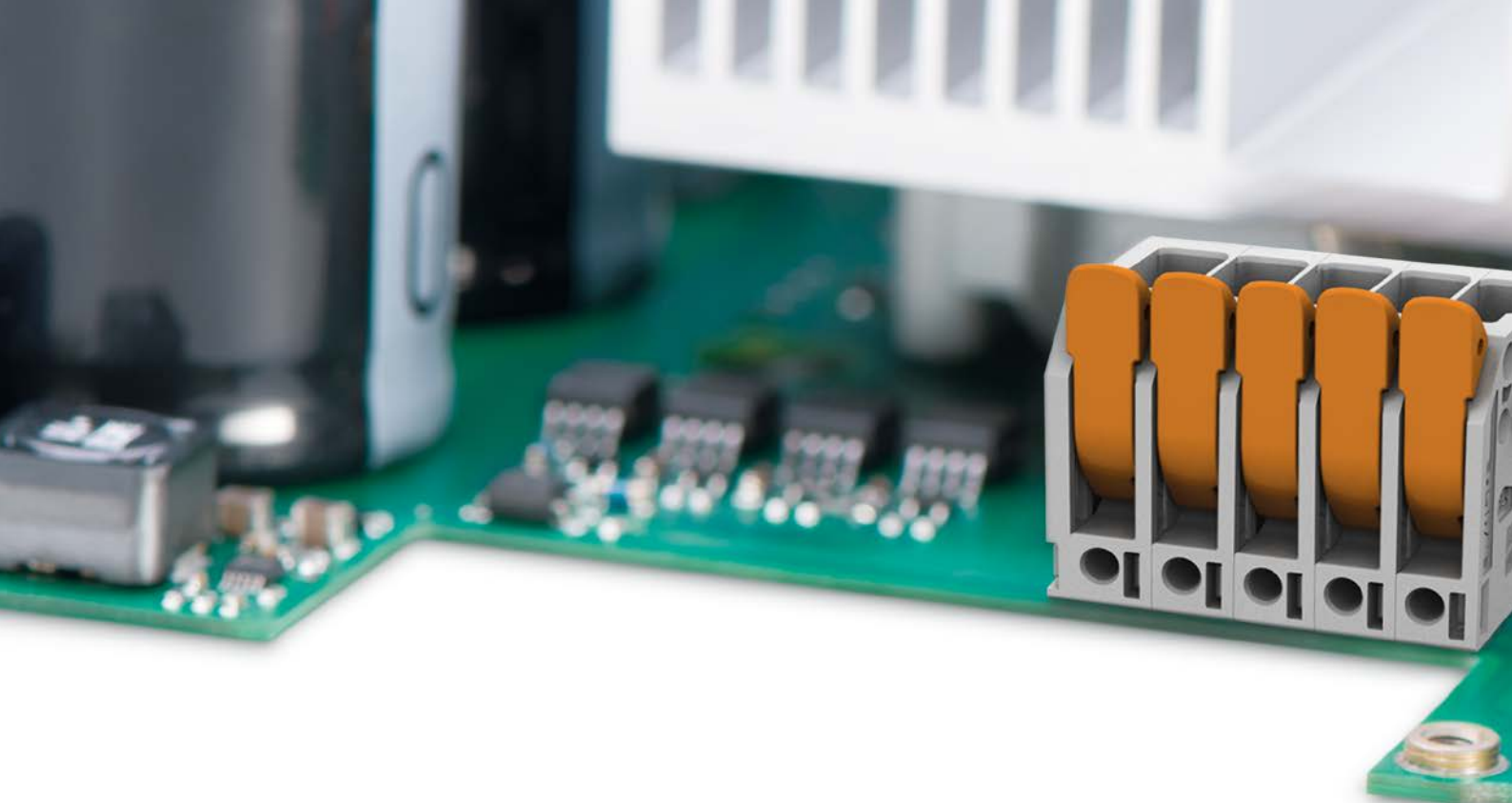

# MORE POWER ON YOUR PCB

## More Power no Longer Means More Space

The trend toward electronic miniaturization requires that both power and signal levels be integrated on PCBs. This results in increased power density, requiring connection technologies and pluggable connectors suited for both compact and high-performance PCB terminal blocks.

Connection technology is also a basic criterion for selecting the right terminal block in demanding applications, such as power supplies, frequency inverters or servo drives. Additional decisive factors include simple and easy operation, as well as wiring flexibility.

### Every Advantage – All in One

WAGO combines all these criteria into a comprehensive and varied range of PCB terminal blocks

for power electronics. WAGO's PCB terminal blocks are rated for 4 mm<sup>2</sup>, 6 mm<sup>2</sup> and 16 mm<sup>2</sup> conductor cross-sections and can be operated either with or without a tool.

The WAGO MCS MAXI 16 Pluggable Connector has a conductor size of 16 mm<sup>2</sup> (6 AWG). Integrated levers enable intuitive actuation without tools for simple, secure in-hand wiring.

The blocks also offer a unique space-saving feature: Beyond their nominal cross-section, the PCB terminal blocks and pluggable connectors connect most solid and fine-stranded conductors up to the next larger cross-section size. This saves space on the PCB and reduces device connection costs.

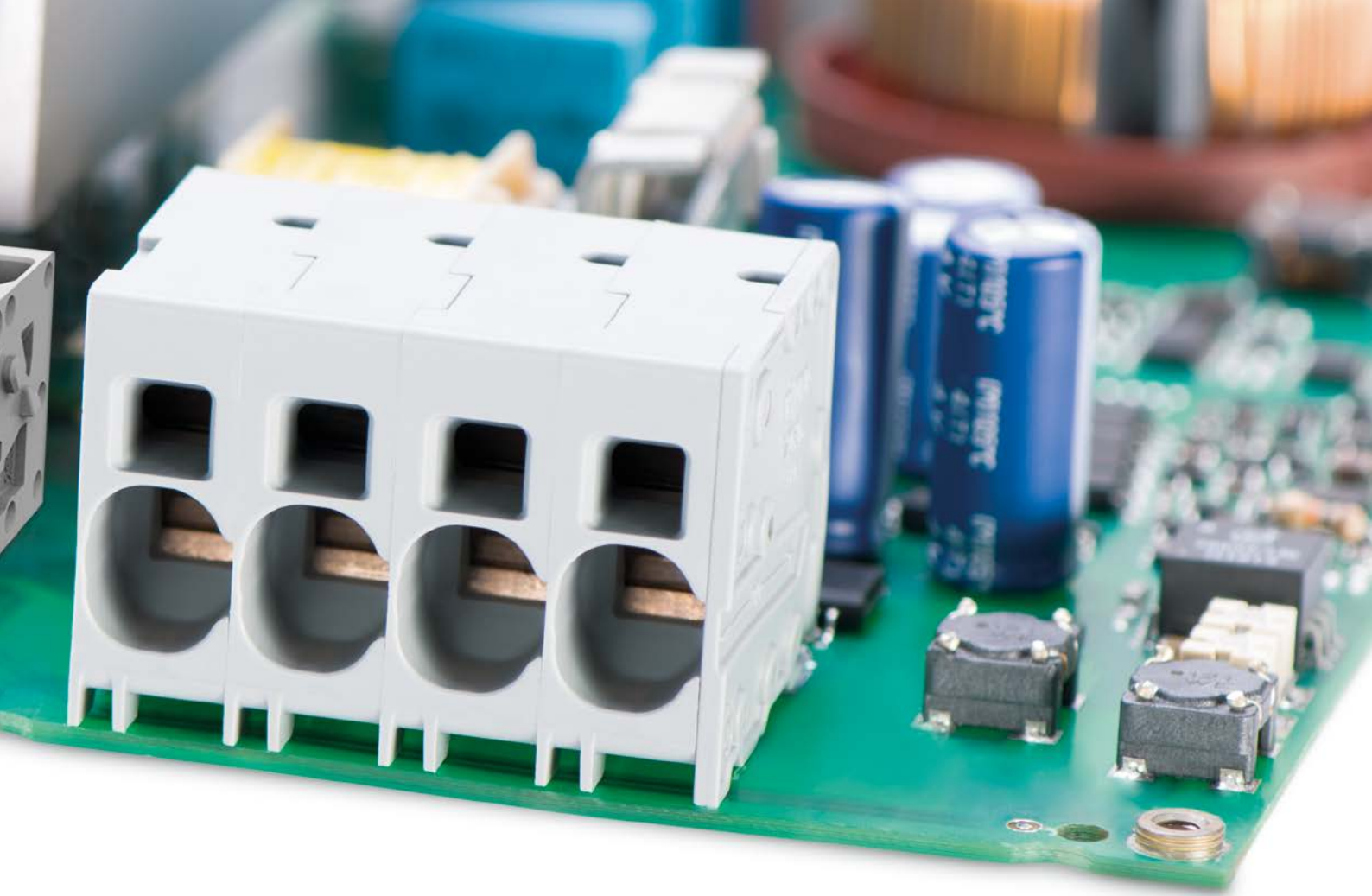

Thanks to WAGO's innovative spring pressure connection technology, the WAGO PCB Terminal Blocks for all applications ideally blend ergonomics and safety. Push-in CAGE CLAMP® enables solid and ferruled conductors to be connected by simply pushing them into the unit, while guaranteeing secure and maintenance-free connections for all conductor types. Furthermore, our products are not only simple and easy to use, but also offer maximum wiring flexibility.

#### **Advantages:**

- Comprehensive product line ranging from 0.2 to 25 mm<sup>2</sup>
- Push-in CAGE CLAMP® termination
- Wider conductor range and higher current carrying capacity
- Conductor connection and mating direction both horizontal and vertical to the PCB
- Testing both parallel and perpendicular to conductor entry

Learn more at:

[www.wago.com/powerelectronics](http://www.wago.com/powerelectronics)

# PCB TERMINAL BLOCKS WITH Push-in CAGE CLAMP®

2624, 2626, 2636 Series

WAGO's PCB terminal blocks with Push-in CAGE CLAMP® are ideal for compact device connections. They are compatible with existing industrial solutions and can be perfectly integrated into both space-limited and panel feedthrough applications.

Push-in CAGE CLAMP® is suitable for all conductor types and enables solid and ferruled conductors to be connected by simply pushing them into the unit. Tool-actuated termination is performed parallel to conductor entry. WAGO's PCB terminal blocks terminate conductors both horizontally and vertically to the PCB. Furthermore, they can be tested both parallel and perpendicular to conductor entry.

## Advantages:

- Compact device connection
- Ideal for panel feedthrough and space-restricted applications
- Operation parallel to conductor entry
- Compatibility with existing industrial solutions
- For applications complying with EN and UL 61800-5-1 (details upon request)



## Conductor Ranges:

[mm <sup>2</sup> ]	0.2	0.34	0.5	0.75	1.5	2.5	4	6	10	16	25	[mm <sup>2</sup> ]	
<b>2624 Series</b>	All conductor types						"s" + "f-st"						Pin spacing: 5 / 7.5 / 11.5 mm
<b>2626 Series</b>	All conductor types								"s" + "f-st"			Pin spacing: 7.5 mm	
<b>2636 Series</b>				All conductor types							"f-st"	Pin spacing: 10 mm	
<b>[AWG]</b>	24	22	20	18	16	14	12	10	8	6	4	<b>[AWG]</b>	

All conductor types including ferruled without restriction
"s" Only solid conductors
 "f-st" Only fine-stranded conductors

# PCB TERMINAL BLOCKS WITH Push-in CAGE CLAMP® AND LEVER

2604, 2606, 2616 Series

WAGO's lever-equipped PCB terminal block variants offer faster and easier wiring. They combine a compact design, high current carrying capacity and the advantages of Push-in CAGE CLAMP® with the benefits of intuitive lever operation.

The lever permits 100% tool-free operation and provides a secure connection when the easy-to-use lever closes the clamping unit. The lever also clearly locks in position (open/close) with a tactile and audible click. WAGO's PCB terminal blocks with levers terminate conductors both horizontally and vertically to the PCB. Furthermore, they can be tested both parallel and perpendicular to conductor entry.

## Advantages:

- Faster and easier wiring
- Tool-free, intuitive lever operation
- Secure connection via easy and effortless lever actuation into closed position
- Lever clearly locks in position (open/close)

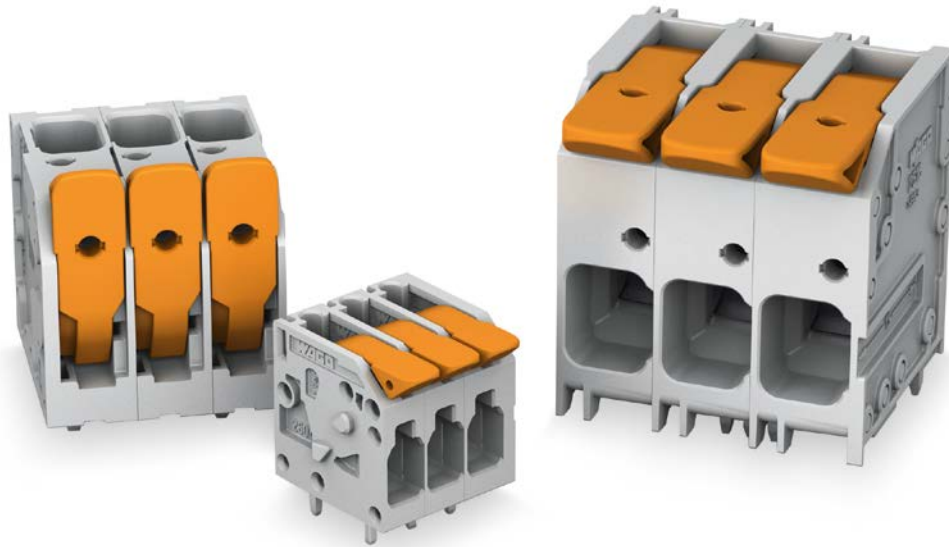

## Conductor Ranges:

[mm <sup>2</sup> ]	0.2	0.34	0.5	0.75	1.5	2.5	4	6	10	16	25	[mm <sup>2</sup> ]	
<b>2604 Series</b>	All conductor types						"s" + "f-st"						Pin spacing: 5 / 7.5 / 11.5 mm
<b>2606 Series</b>	All conductor types								"s" + "f-st"			Pin spacing: 7.5 mm	
<b>2616 Series</b>				All conductor types							"f-st"	Pin spacing: 10 mm	
<b>[AWG]</b>	24	22	20	18	16	14	12	10	8	6	4	<b>[AWG]</b>	

All conductor types including ferruled without restriction

"s" Only solid conductors

"f-st" Only fine-stranded conductors

# 2624 SERIES

- PCB terminal block (4 mm<sup>2</sup>) with tool operation and Push-in CAGE CLAMP®
- Straight or angled type
- Ideal for panel feedthrough applications via operation parallel to conductor entry

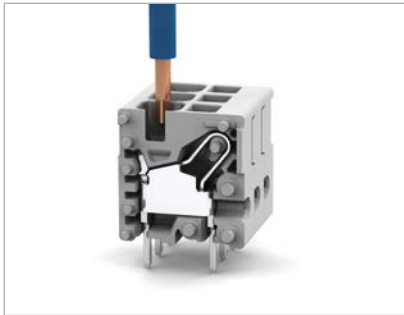

Push-in termination of solid conductors

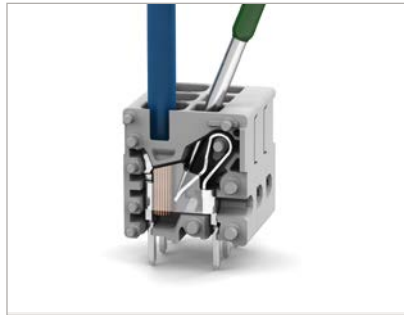

Insert fine-stranded conductors and remove all conductor types via operating tool.

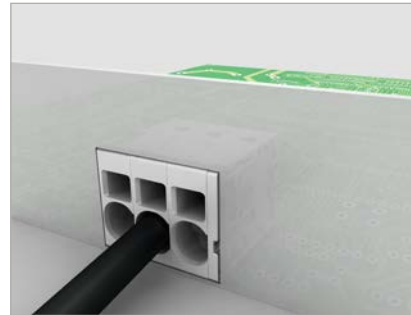

PCB terminal block for panel feedthrough connections

2624 Series						
Pin spacing	5 mm	7.5 mm	11.5 mm	Conductor Data		
Ratings per	IEC/EN 60664-1			Connection technology	Push-in CAGE CLAMP®	
Nominal voltage (III / 3)	320 V	630 V	1000 V	Conductor range: solid	0.2 ... 6 mm <sup>2</sup>	
Rated voltage (III / 2)	400 V	630 V	1000 V	Conductor range: fine-stranded	0.2 ... 6 mm <sup>2</sup>	
Nominal voltage (II / 2)	630 V	1000 V	1000 V	Conductor range: fine-stranded	0.25 ... 2.5 mm <sup>2</sup> (with insulated ferrule)	
Rated surge voltage	4 kV	6 kV	8 kV	Conductor range: fine-stranded	0.25 ... 2.5 mm <sup>2</sup> (with uninsulated ferrule)	
Rated current	32 A			AWG	24 ... 10	
UL 1059 / Use Group C		26 A 150 V	26 A 600 V	Strip length	10 ... 12 mm	
Pole No.	Item No.					
Pin spacing	5 mm	7.5 mm	11.5 mm	5 mm	7.5 mm	11.5 mm
	Angled			Straight		
1	2624-1101			2624-3101		
2	2624-1102	2624-1302	2624-1502	2624-3102	2624-3302	2624-3502
3	2624-1103	2624-1303	2624-1503	2624-3103	2624-3303	2624-3503
4	2624-1104	2624-1304	2624-1504	2624-3104	2624-3304	2624-3504
5	2624-1105	2624-1305	2624-1505	2624-3105	2624-3305	2624-3505
6	2624-1106	2624-1306	2624-1506	2624-3106	2624-3306	2624-3506
7	2624-1107	2624-1307	2624-1507	2624-3107	2624-3307	2624-3507
8	2624-1108	2624-1308	2624-1508	2624-3108	2624-3308	2624-3508
9	2624-1109	2624-1309	2624-1509	2624-3109	2624-3309	2624-3509
10	2624-1110	2624-1310	2624-1510	2624-3110	2624-3310	2624-3510
11	2624-1111	2624-1311	2624-1511	2624-3111	2624-3311	2624-3511
12	2624-1112	2624-1312	2624-1512	2624-3112	2624-3312	2624-3512

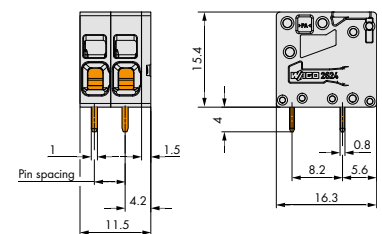
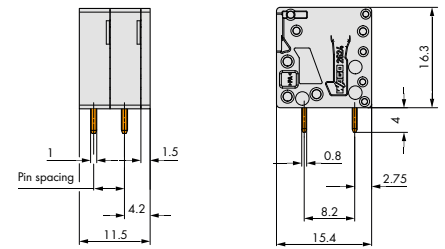

Footprint (top view)

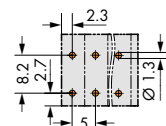

Learn more at:  
[www.wago.com/2624](http://www.wago.com/2624)

# 2604 SERIES

- PCB terminal block (4 mm<sup>2</sup>) with lever and Push-in CAGE CLAMP®
- 100% tool-free operation
- Connection is secured when easy-to-use lever is lowered into closed position
- Lever clearly locks in position (open/close)
- Straight or angled type



Push-in termination of solid conductors

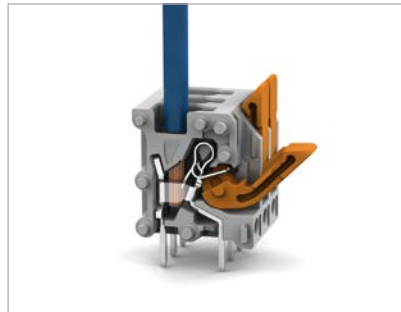

Insert fine-stranded conductors – and remove all conductors – via operating tool.



PCB terminal block for power supplies

2604 Series						
Pin spacing	5 mm	7.5 mm	11.5 mm	Conductor Data		
Ratings per	IEC/EN 60664-1			Connection technology	Push-in CAGE CLAMP®	
Nominal voltage (III / 3)	320 V	630 V	1000 V	Conductor range: solid	0.2 ... 4 mm <sup>2</sup>	
Rated voltage (III / 2)	400 V	630 V	1000 V	Conductor range: fine-stranded	0.2 ... 4 mm <sup>2</sup>	
Nominal voltage (II / 2)	630 V	1000 V	1000 V	Conductor range: fine-stranded	0.25 ... 2.5 mm <sup>2</sup> (with insulated ferrule)	
Rated surge voltage	4 kV	6 kV	8 kV	Conductor range: fine-stranded	0.25 ... 2.5 mm <sup>2</sup> (with uninsulated ferrule)	
Rated current	32 A			AWG	24 ... 12	
UL 1059 / Use Group C		20 A 300 V	20 A 600 V	Strip length	9 ... 11 mm	
Pole No.	Item No.					
Pin spacing	5 mm	7.5 mm	11.5 mm	5 mm	7.5 mm	11.5 mm
	Angled			Straight		
1	2604-1101			2604-3101		
2	2604-1102	2604-1302	2604-1502	2604-3102	2604-3302	2604-3502
3	2604-1103	2604-1303	2604-1503	2604-3103	2604-3303	2604-3503
4	2604-1104	2604-1304	2604-1504	2604-3104	2604-3304	2604-3504
5	2604-1105	2604-1305	2604-1505	2604-3105	2604-3305	2604-3505
6	2604-1106	2604-1306	2604-1506	2604-3106	2604-3306	2604-3506
7	2604-1107	2604-1307	2604-1507	2604-3107	2604-3307	2604-3507
8	2604-1108	2604-1308	2604-1508	2604-3108	2604-3308	2604-3508
9	2604-1109	2604-1309	2604-1509	2604-3109	2604-3309	2604-3509
10	2604-1110	2604-1310	2604-1510	2604-3110	2604-3310	2604-3510
11	2604-1111	2604-1311	2604-1511	2604-3111	2604-3311	2604-3511
12	2604-1112	2604-1312	2604-1512	2604-3112	2604-3312	2604-3512

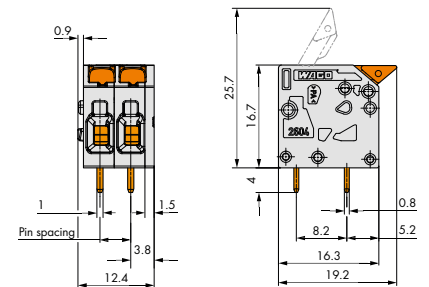
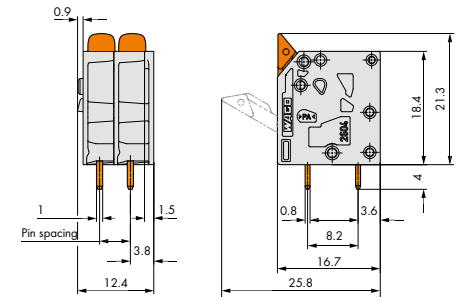

Footprint (top view)

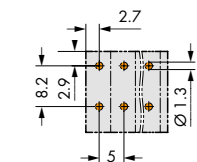

Learn more at:  
[www.wago.com/2604](http://www.wago.com/2604)

# 2626 SERIES

- PCB terminal block (6 mm<sup>2</sup>) with tool operation and Push-in CAGE CLAMP®
- Straight or angled type
- Ideal for panel feedthrough applications via operation parallel to conductor entry

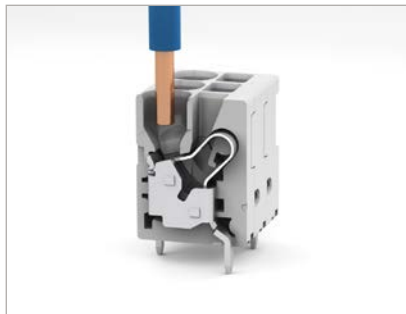

Push-in termination of solid conductors



Insert fine-stranded conductors and remove all conductor types via operating tool.

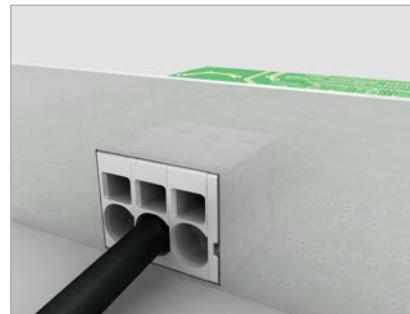

PCB terminal block for panel feed-through connections

2626 Series			
Pin spacing	7.5 mm	Conductor Data	
Ratings per	IEC/EN 60664-1	Connection technology	Push-in CAGE CLAMP®
Nominal voltage (III / 3)	800 V	Conductor range: solid	0.2 ... 10 mm <sup>2</sup>
Rated voltage (III / 2)	1000 V	Conductor range: fine-stranded	0.2 ... 10 mm <sup>2</sup>
Nominal voltage (II / 2)	1000 V	Conductor range: fine-stranded	0.25 ... 6 mm <sup>2</sup> (with insulated ferrule)
Rated surge voltage	8 kV	Conductor range: fine-stranded	0.25 ... 6 mm <sup>2</sup> (with uninsulated ferrule)
Rated current	41 A	AWG	24 ... 8
UL 1059 / Use Group C*	35 A 600 V	Strip length	13 ... 15 mm
Pole No.	Item No.		
	Angled	Straight	
1	2626-1101	2626-3101	
2	2626-1102/0020-0000	2626-3102/0020-0000	
3	2626-1103/0020-0000	2626-3103/0020-0000	
4	2626-1104/0020-0000	2626-3104/0020-0000	
5	2626-1105/0020-0000	2626-3105/0020-0000	
6	2626-1106/0020-0000	2626-3106/0020-0000	
7	2626-1107/0020-0000	2626-3107/0020-0000	
8	2626-1108/0020-0000	2626-3108/0020-0000	
9	2626-1109/0020-0000	2626-3109/0020-0000	
10	2626-1110/0020-0000	2626-3110/0020-0000	
11	2626-1111/0020-0000	2626-3111/0020-0000	
12	2626-1112/0020-0000	2626-3112/0020-0000	

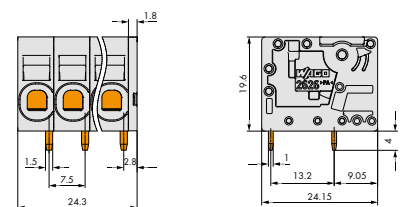
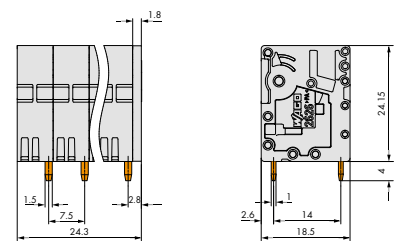

Footprint (top view)

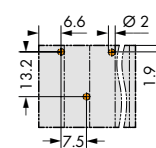

Learn more at:

[www.wago.com/2626](http://www.wago.com/2626)

# 2606 SERIES

- PCB terminal block (6 mm<sup>2</sup>) with lever and Push-in CAGE CLAMP®
- 100% tool-free operation
- Connection is secured when easy-to-use lever is lowered into closed position
- Lever clearly locks in position (open/close)
- Straight or angled type



Push-in termination of solid conductors



Insert fine-stranded conductors – and remove all conductors – via operating tool.



PCB terminal block for power supplies

2606 Series			
Pin spacing	7.5 mm	Conductor Data	
Ratings per	IEC/EN 60664-1	Connection technology	Push-in CAGE CLAMP®
Nominal voltage (III / 3)	800 V	Conductor range: solid	0.2 ... 10 mm <sup>2</sup>
Rated voltage (III / 2)	1000 V	Conductor range: fine-stranded	0.2 ... 10 mm <sup>2</sup>
Nominal voltage (II / 2)	1000 V	Conductor range: fine-stranded	0.25 ... 6 mm <sup>2</sup> (with insulated ferrule)
Rated surge voltage	8 kV	Conductor range: fine-stranded	0.25 ... 6 mm <sup>2</sup> (with uninsulated ferrule)
Rated current	41 A	AWG	24 ... 8
UL 1059 / Use Group C*	31 A 600 V	Strip length	11 ... 13 mm
Pole No.	Item No.		Straight
	Angled		
1	2606-1101		2606-3101
2	2606-1102/0020-0000		2606-3102/0020-0000
3	2606-1103/0020-0000		2606-3103/0020-0000
4	2606-1104/0020-0000		2606-3104/0020-0000
5	2606-1105/0020-0000		2606-3105/0020-0000
6	2606-1106/0020-0000		2606-3106/0020-0000
7	2606-1107/0020-0000		2606-3107/0020-0000
8	2606-1108/0020-0000		2606-3108/0020-0000
9	2606-1109/0020-0000		2606-3109/0020-0000
10	2606-1110/0020-0000		2606-3110/0020-0000
11	2606-1111/0020-0000		2606-3111/0020-0000
12	2606-1112/0020-0000		2606-3112/0020-0000

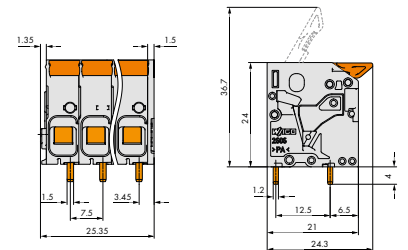
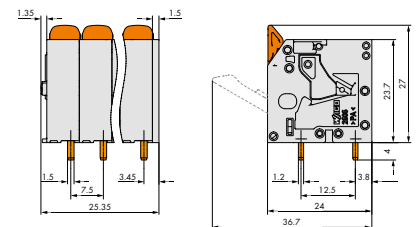

Footprint (top view)

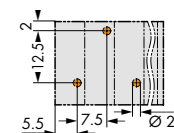

Learn more at:  
[www.wago.com/2606](http://www.wago.com/2606)

# 2636 SERIES

- PCB terminal block (16 mm<sup>2</sup>) with tool operation and Push-in CAGE CLAMP®
- Straight or angled type
- Ideal for panel feedthrough applications via operation parallel to conductor entry



Push-in termination of solid conductors



Insert fine-stranded conductors and remove all conductor types via operating tool.

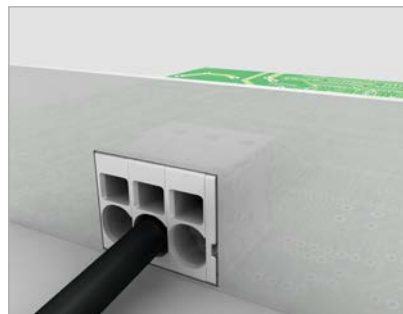

PCB terminal block for panel feedthrough connections

2636 Series			
Pin spacing	10 mm	Conductor Data	
Ratings per	IEC/EN 60664-1	Connection technology	Push-in CAGE CLAMP®
Nominal voltage (III / 3)	1000 V	Conductor range: solid	0.75 ... 16 mm <sup>2</sup>
Rated voltage (III / 2)	1000 V	Conductor range: fine-stranded	0.75 ... 25 mm <sup>2</sup>
Nominal voltage (II / 2)	1000 V	Conductor range: fine-stranded	0.75 ... 16 mm <sup>2</sup> (with insulated ferrule)
Rated surge voltage	8 kV	Conductor range: fine-stranded	0.75 ... 16 mm <sup>2</sup> (with uninsulated ferrule)
Rated current	76 A	AWG	18 ... 4
UL 1059 / Use Group C*	66 A 600 V	Strip length	18 ... 20 mm
Pole No.	Item No.		
	Angled	Straight	
1	2636-1101	2636-3101	
2	2636-1102/0020-0000	2636-3102/0020-0000	
3	2636-1103/0020-0000	2636-3103/0020-0000	
4	2636-1104/0020-0000	2636-3104/0020-0000	
5	2636-1105/0020-0000	2636-3105/0020-0000	
6	2636-1106/0020-0000	2636-3106/0020-0000	
7	2636-1107/0020-0000	2636-3107/0020-0000	
8	2636-1108/0020-0000	2636-3108/0020-0000	
9	2636-1109/0020-0000	2636-3109/0020-0000	
10	2636-1110/0020-0000	2636-3110/0020-0000	
11	2636-1111/0020-0000	2636-3111/0020-0000	
12	2636-1112/0020-0000	2636-3112/0020-0000	

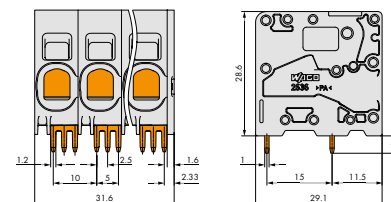
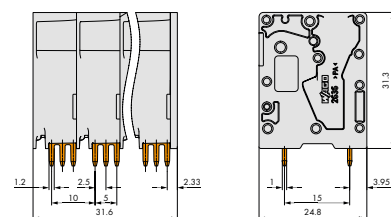

Footprint (top view)

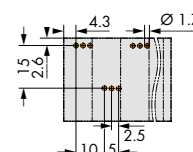

Learn more at:

[www.wago.com/2636](http://www.wago.com/2636)

# 2616 SERIES

- PCB terminal block (16 mm<sup>2</sup>) with lever and Push-in CAGE CLAMP®
- 100% tool-free operation
- Connection is secured when easy-to-use lever is lowered into closed position
- Lever clearly locks in position (open/close)
- Straight or angled type

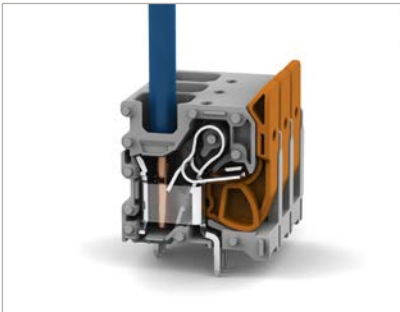

Push-in termination of solid conductors

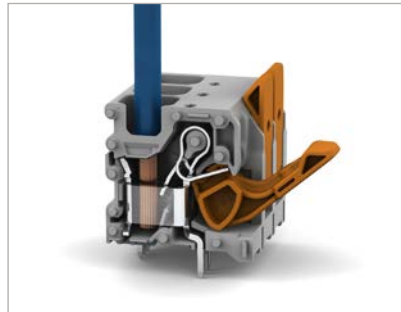

Insert fine-stranded conductors – and remove all conductors – via operating tool.

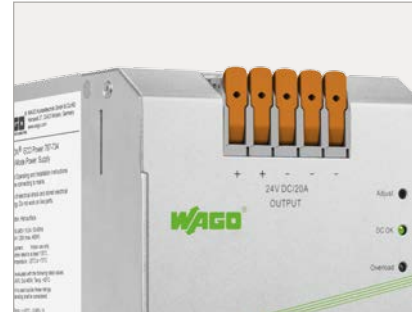

PCB terminal block for power supplies

2616 Series			
Pin spacing	10 mm	Conductor Data	
Ratings per	IEC/EN 60664-1	Connection technology	Push-in CAGE CLAMP®
Nominal voltage (III / 3)	1000 V	Conductor range: solid	0.75 ... 16 mm <sup>2</sup>
Rated voltage (III / 2)	1000 V	Conductor range: fine-stranded	0.75 ... 25 mm <sup>2</sup>
Nominal voltage (II / 2)	1000 V	Conductor range: fine-stranded (with insulated ferrule)	0.75 ... 16 mm <sup>2</sup>
Rated surge voltage	8 kV	Conductor range: fine-stranded (with uninsulated ferrule)	0.75 ... 16 mm <sup>2</sup>
Rated current	76 A	AWG	18 ... 4
UL 1059 / Use Group C*	66 A 600 V	Strip length	18 ... 20 mm
Pole No.	Item No.		
	Angled	Straight	
1	2616-1101	2616-3101	
2	2616-1102/0020-0000	2616-3102/0020-0000	
3	2616-1103/0020-0000	2616-3103/0020-0000	
4	2616-1104/0020-0000	2616-3104/0020-0000	
5	2616-1105/0020-0000	2616-3105/0020-0000	
6	2616-1106/0020-0000	2616-3106/0020-0000	
7	2616-1107/0020-0000	2616-3107/0020-0000	
8	2616-1108/0020-0000	2616-3108/0020-0000	
9	2616-1109/0020-0000	2616-3109/0020-0000	
10	2616-1110/0020-0000	2616-3110/0020-0000	
11	2616-1111/0020-0000	2616-3111/0020-0000	
12	2616-1112/0020-0000	2616-3112/0000-0020	

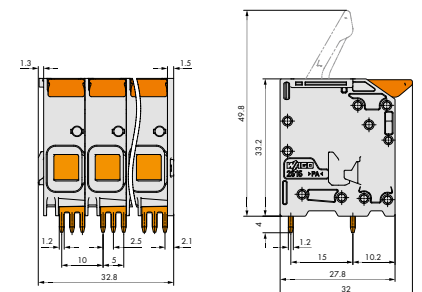
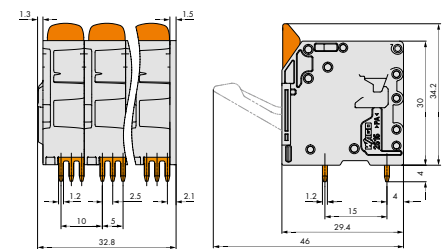

Footprint (top view)

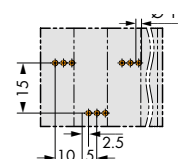

Learn more at:  
[www.wago.com/2616](http://www.wago.com/2616)

# LEVERAGE CONVENIENCE

## Pluggable PCB Connectors with Levers – Connect Conductors up to 25 mm<sup>2</sup> (4 AWG)

For wiring sub-assemblies in the field, highly accessible and simple-to-operate connection points are essential. WAGO is literally leveraging its expertise with the *MCS MAXI 16* by offering the world's first pluggable connectors with a lever for intuitive, tool-free handling. With this feature, connectors can be wired in-hand, easily and quickly. Furthermore, simply lowering the lever always ensures a reliable contact.

Both wire-to-wire and wire-to-board versions of pluggable PCB connectors are available and designed for a nominal cross-section of 16 mm<sup>2</sup> (6 AWG). The top advantage where space is at a premium: Beyond their specific nominal cross-section, the PCB terminal blocks connect most solid and fine-stranded conductors up to the next larger cross-section size. The pluggable connectors are equipped with Push-in CAGE CLAMP® technology for all conductor types, allowing direct

insertion of solid and fine-stranded conductors with ferrules.

### Flexible Coding – Fast Adaptation

The coding of the new *MCS MAXI 16* pluggable connectors brings additional benefits: They are coded internally, simplifying individual coding changes – even when the pluggable connector is already installed in the enclosure. Complicated adjustments to the enclosure cutout are no longer required. Another unique feature is the ability to quickly and easily recode when plugged in. To keep installation simple and minimize the number of assemblies, the male and female headers come in the same symmetrically formed coding finger.

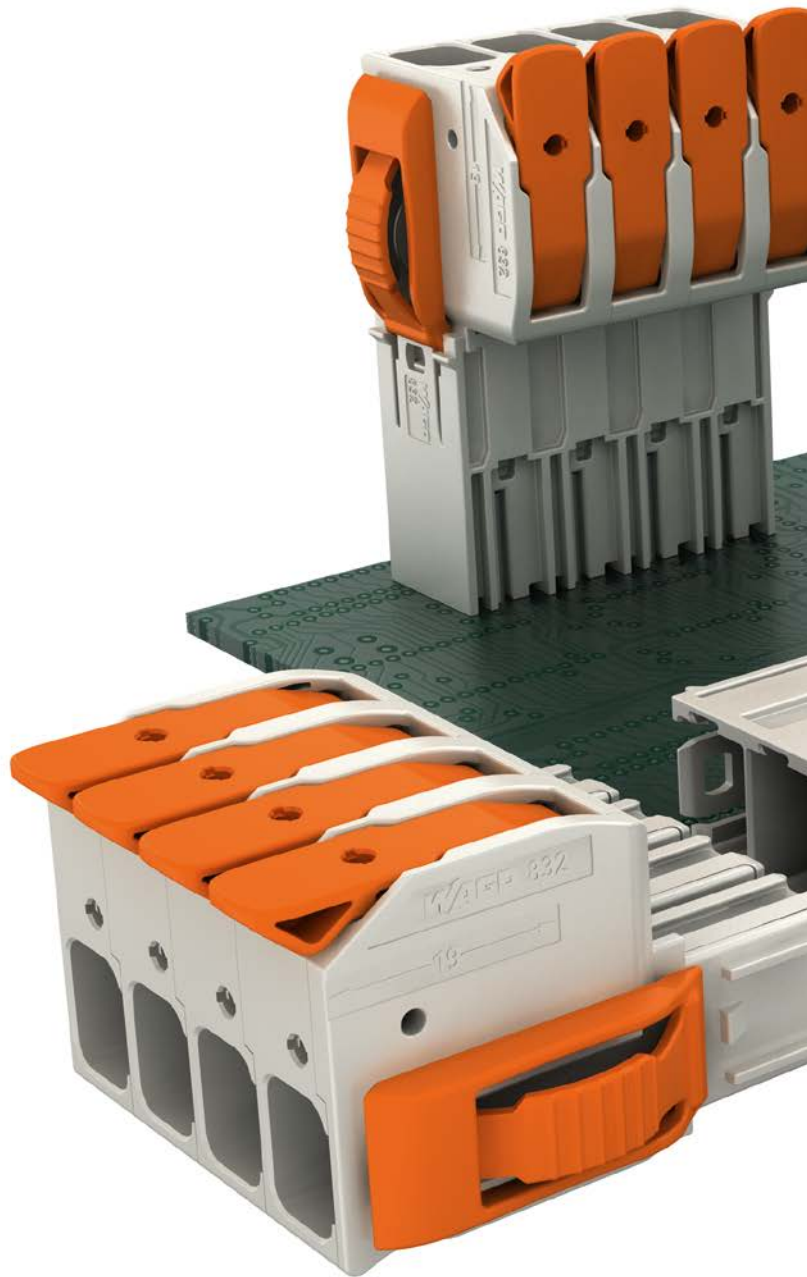

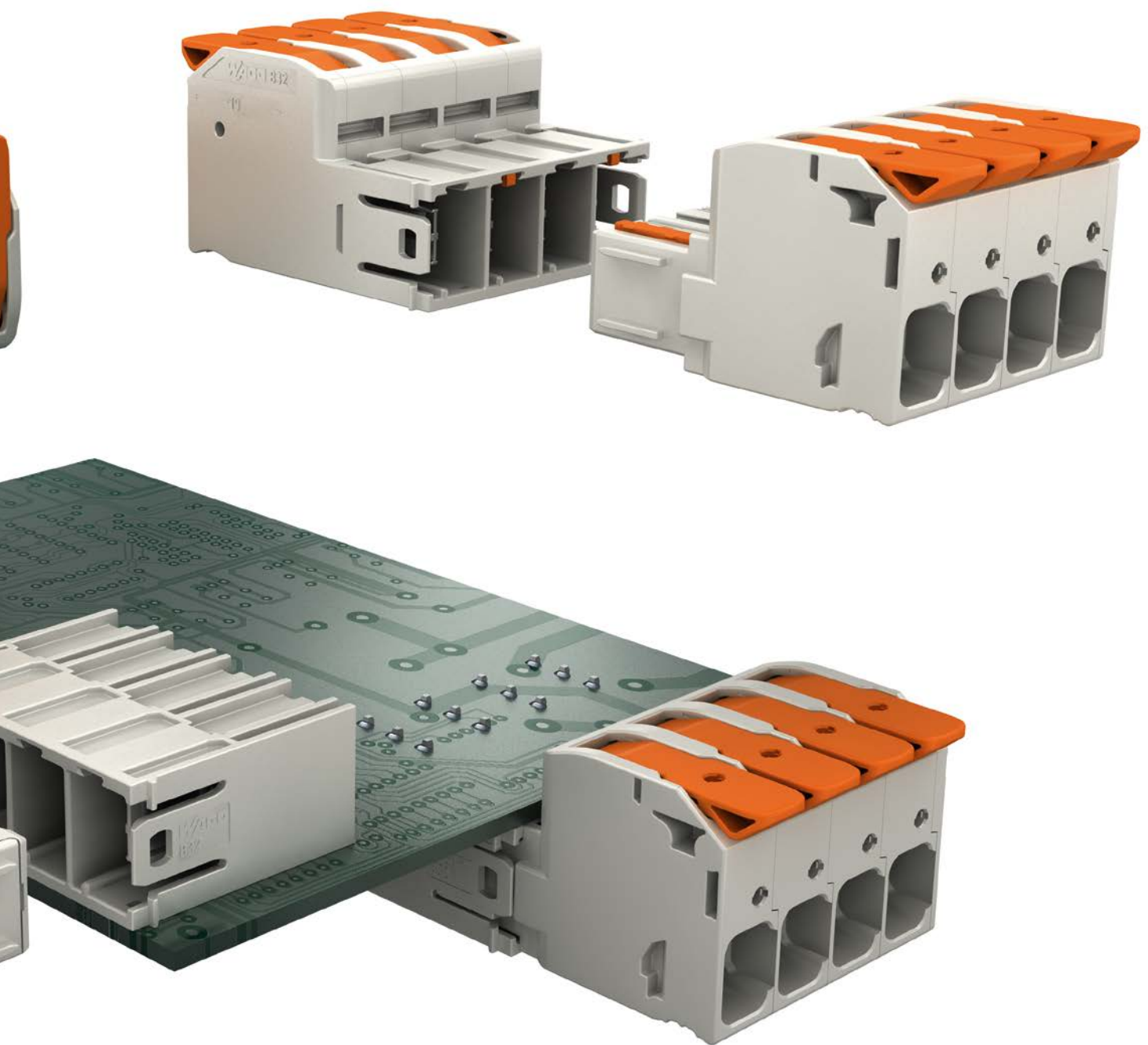

## 100% Safety

As with all MCS products, the new pluggable connectors also provide 100% protection against mismatching to ensure maximum safety for field wiring. The integrated protective contact caps within the interface of the male header ensure additional user safety when unplugged.

Yet another highlight: An optional interlock enables fast, reliable connection and also prevents accidental disconnection.

## Advantages:

- Easy in-hand wiring via lever actuation
- Tool-free, intuitive lever operation
- Product portfolio from 0.75 to 25 mm<sup>2</sup> (18–4 AWG)
- Push-in CAGE CLAMP® termination
- Wider conductor range and higher current carrying capacity
- 100% protected against mismatching
- Coding and locking options available

Learn more at:

[www.wago.com/powerelectronics](http://www.wago.com/powerelectronics)



# 1-CONDUCTOR MALE CONNECTORS WITH LEVERS

- Male connectors with levers and Push-in CAGE CLAMP®
- For wire-to-wire applications
- Insert solid and fine-stranded ferruled conductors via push-in termination
- Test slot 0° and 90° to conductor entry
- Secure connection via simple, effortless lever actuation into closed position



832-120x Series			
Pin spacing	10.16 mm	Conductor Data	
Ratings per	IEC/EN 60664-1	Connection technology	Push-in CAGE CLAMP®
Nominal voltage (III / 3)	1000 V	Conductor range: solid	0.75 ... 16 mm <sup>2</sup>
Rated voltage (III / 2)	1000 V	Conductor range: fine-stranded	0.75 ... 25 mm <sup>2</sup>
Nominal voltage (II / 2)	1000 V	Conductor range: fine-stranded	0.75 ... 16 mm <sup>2</sup> (with insulated ferrule)
Rated surge voltage	8 kV	Conductor range: fine-stranded	0.75 ... 16 mm <sup>2</sup> (with uninsulated ferrule)
Rated current	76 A	AWG	18 ... 4
		Strip length	18 ... 20 mm
Pole No.	Item No.		
	1-conductor male connector; light gray		
2	832-1202		
3	832-1203		
4	832-1204		
5	832-1205		
6	832-1206		

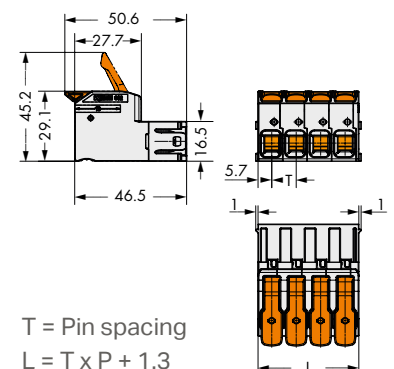

Learn more at:  
[www.wago.com/832](http://www.wago.com/832)

# THT MALE HEADERS

- Soldered male headers may be mounted horizontally or vertically via straight or angled solder pins
- Three solder pins per pole provide high electrical and mechanical stability
- Increased contact safety in pin array (IP2XB)

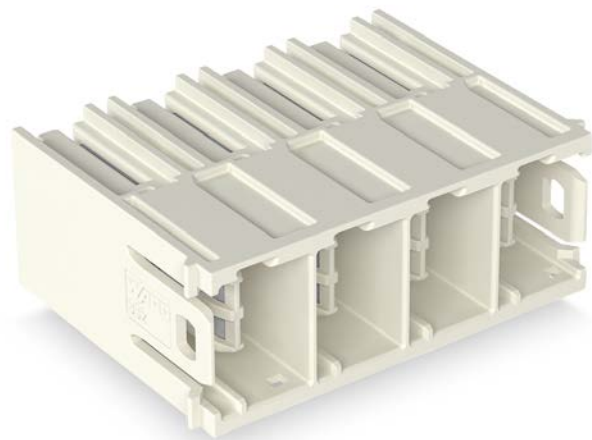

MCS MAXI 16 is ideal for enclosure cutouts.

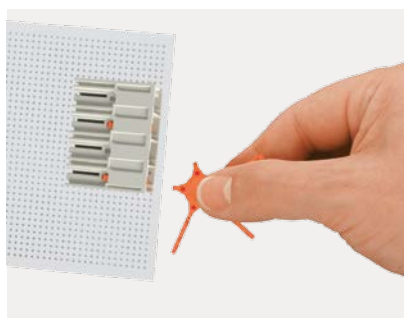

Easy coding thanks to symmetrical coding keys in both male and female connectors



Coding star (item no. 832-500)

832-36xx Series			
Pin spacing	10.16 mm	Solder Pin Data	
Ratings per	IEC/EN 60664-1	Solder pin length	4 mm
Nominal voltage (III / 3)	800 V	Solder pin dimensions	1.2 x 1.2 mm
Rated voltage (III / 2)	1000 V	Drilled hole diameter with tolerance	1.7 <sup>+0.1</sup> mm
Nominal voltage (II / 2)	1000 V		
Rated surge voltage	8 kV		
Rated current	76 A		
Pole No.	Item No.		
	THT male header; with straight solder pins; light gray	THT male header; with solder pins angled upwards; light gray	THT male header; with solder pins angled downwards; light gray
2	832-3602	832-3622	832-3642
3	832-3603	832-3623	832-3643
4	832-3604	832-3624	832-3644
5	832-3605	832-3625	832-3645
6	832-3606	832-3626	832-3646

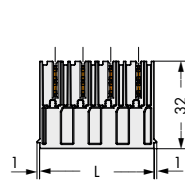
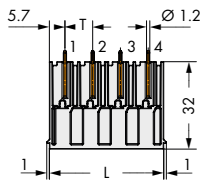
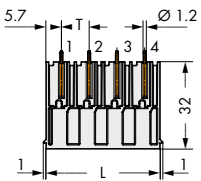
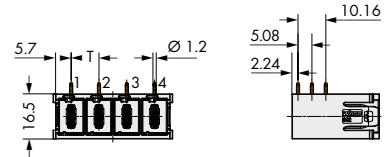
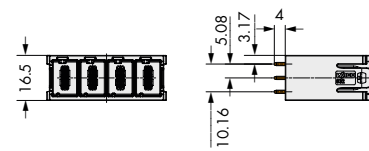
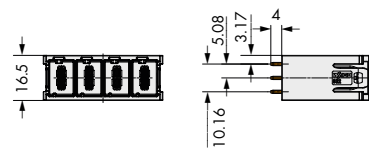
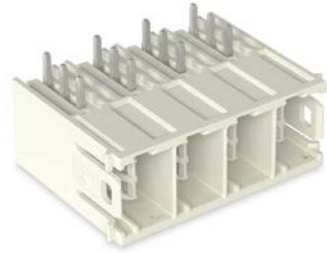
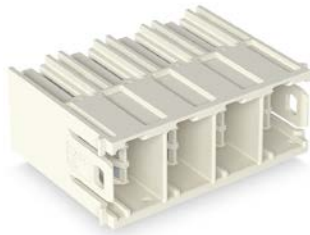

T = Pin spacing  
L = T x P + 1.3

Footprint (top view)

Footprint (top view)

Footprint (top view)

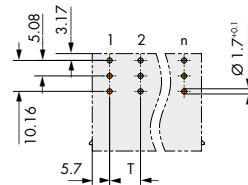
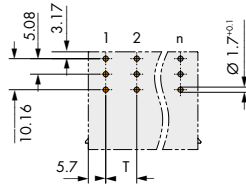
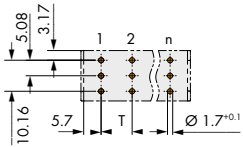

Cutouts for male headers with solder pins

Cutout for male headers with solder pins (with locking device)

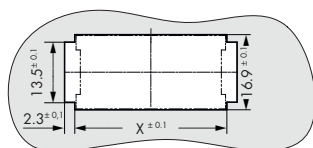
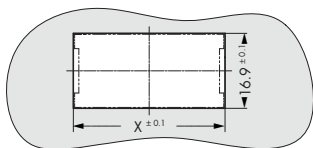

Pole No.	X
2	24.1
3	34.2
4	44.4
5	54.6
6	64.7

Learn more at:  
[www.wago.com/832](http://www.wago.com/832)



# SYSTEM HIGHLIGHTS

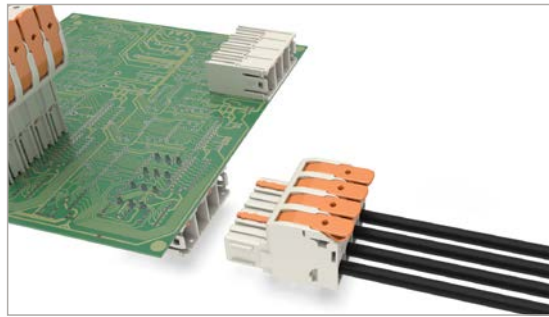
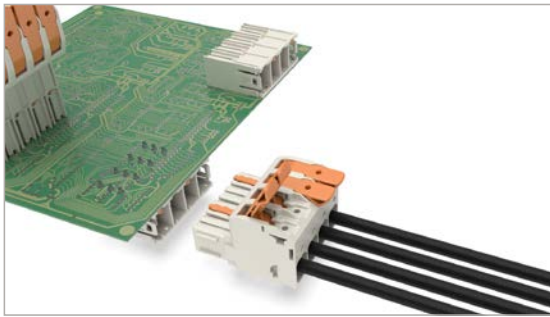

## Lever Actuation

Easy in-hand wiring via lever actuation



Fast and easy in-hand wiring

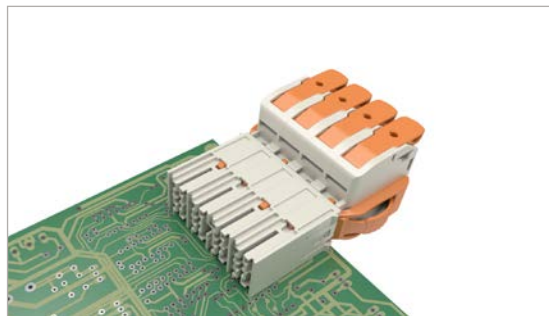

## Locking Levers

Easy and secure plugging with automatic locking; the optional locking prevents accidental disconnection.

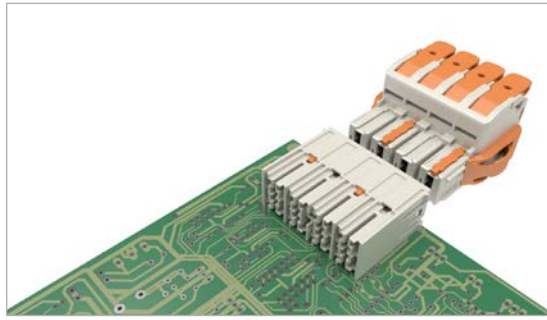
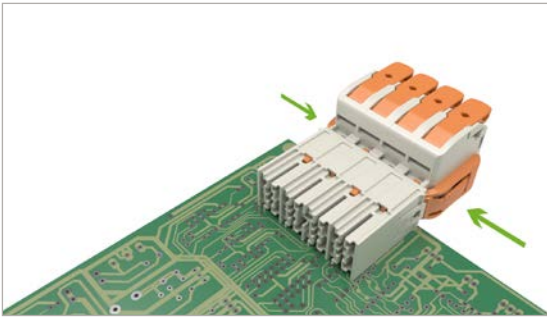

Easy and intuitive disconnection via innovative locking

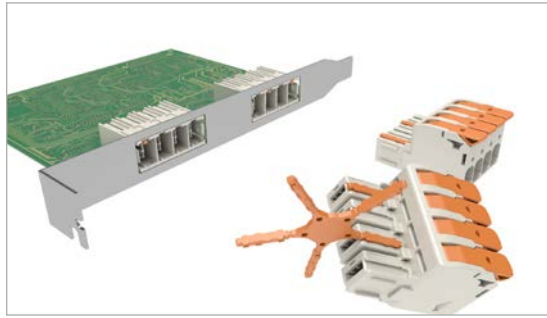

### Coding

Easy coding thanks to symmetrical coding keys in both male and female connector

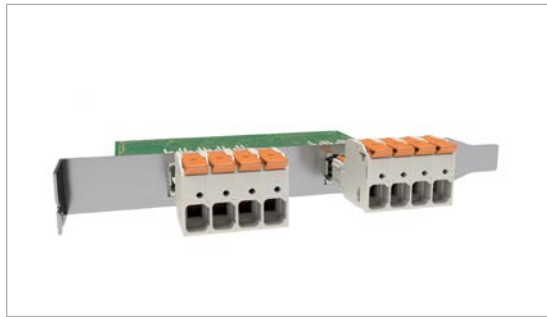
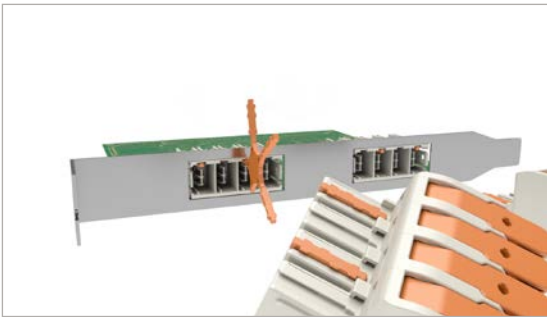

Recoding even when plugged in



**WAGO Kontakttechnik GmbH & Co. KG**

Postfach 2880 · 32385 Minden, Germany

Hansastraße 27 · 32423 Minden

[info@wago.com](mailto:info@wago.com)

[www.wago.com](http://www.wago.com)

Headquarters +49 571/ 887 - 0

Sales +49 571/ 887 - 222

Orders +49 571/ 887 - 44333

Fax +49 571/ 887 - 8 44169

WAGO is a registered trademark of WAGO Verwaltungsgesellschaft mbH.

“Copyright – WAGO Kontakttechnik GmbH & Co. KG – All rights reserved. The content and structure of the WAGO websites, catalogs, videos and other WAGO media are subject to copyright. Distribution or modification to the contents of these pages and videos is prohibited. Furthermore, the content may neither be copied nor made available to third parties for commercial purposes. Also subject to copyright are the images and videos that were made available to WAGO Kontakttechnik GmbH & Co. KG by third parties.”