

Product datasheet

Specifications



Harmony XVU, Fixing plate for use on vertical support for modular tower lights, black, Ø60

XVUZ12

EAN Code: 3606480887154

Main

Range of product	Harmony XVU
Product or component type	Modular tower light
accessory / separate part type	Fixing plate
Accessory / separate part category	Mounting and fixing accessory
Component name	XVU
Mounting diameter	60 mm

Complementary

Mounting support	Wall mounted
Product compatibility	XVUZ05 XVUZ800 XVUZ400 XVUZ02Q XVUZ02
Material	Aluminium V-0 conforming to UL 94
Housing colour	Black
[Us] rated supply voltage	24 V AC/DC 110...240 V AC
Length	8 mm
Net weight	0.36 kg

Environment

Ambient air temperature for storage	-40...70 °C
Ambient air temperature for operation	-25...50 °C
IP degree of protection	IP65
Product certifications	CSA UL CE

Packing Units

Unit Type of Package 1	PCE
Number of Units in Package 1	1
Package 1 Height	5.068 cm
Package 1 Width	6.844 cm
Package 1 Length	11.412 cm

Package 1 Weight	491.0 g
Unit Type of Package 2	CAR
Number of Units in Package 2	10
Package 2 Height	15.6 cm
Package 2 Width	15.3 cm
Package 2 Length	39.8 cm
Package 2 Weight	5.651 kg

Contractual warranty

Warranty	18 months
----------	-----------

Sustainability

Green Premium™ label is Schneider Electric's commitment to delivering products with best-in-class environmental performance. Green Premium promises compliance with the latest regulations, transparency on environmental impacts, as well as circular and low-CO₂ products.

Guide to assessing product sustainability is a white paper that clarifies global eco-label standards and how to interpret environmental declarations.

[Learn more about Green Premium >](#)

[Guide to assess a product's sustainability >](#)



Transparency RoHS/REACH

Well-being performance

Mercury Free

RoHS Exemption Information Yes

Certifications & Standards

Reach Regulation [REACH Declaration](#)

Eu RoHS Directive Pro-active compliance (Product out of EU RoHS legal scope)

China RoHS Regulation [China RoHS declaration](#)

Environmental Disclosure [Product Environmental Profile](#)

Circularity Profile [End of Life Information](#)

Dimensions Drawings

Dimensions

Rear View

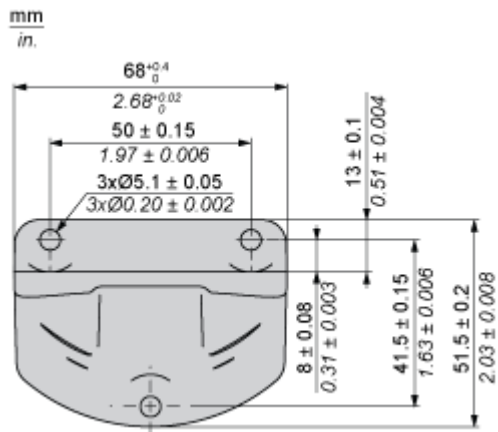

Side View

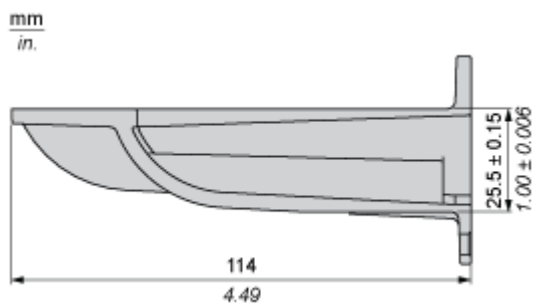

Mounting and Clearance

Vertical Support Panel Drillings

