



### Model Number

NBB2-12GM50-E0

### Features

- 2 mm flush

### Connection

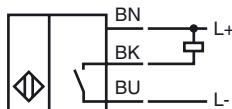

### Accessories

#### BF 12

Mounting flange, 12 mm

#### EXG-12

Quick mounting bracket with dead stop

### Dimensions

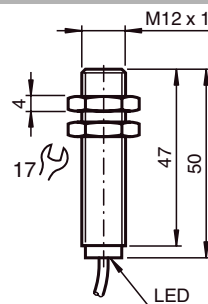

### Technical Data

#### General specifications

Switching element function		NPN	NO
Rated operating distance	$s_n$	2 mm	
Installation		flush	
Output polarity		DC	
Assured operating distance	$s_a$	0 ... 1.62 mm	
Reduction factor $r_{Al}$		0.3	
Reduction factor $r_{Cu}$		0.2	
Reduction factor $r_{304}$		0.7	

#### Nominal ratings

Operating voltage	$U_B$	10 ... 30 V	
Switching frequency	$f$	0 ... 1500 Hz	
Reverse polarity protection		reverse polarity protected	
Short-circuit protection		pulsing	
Voltage drop	$U_d$	$\leq 3$ V	
Operating current	$I_L$	0 ... 200 mA	
Off-state current	$I_r$	0 ... 0.5 mA typ. 0.1 $\mu$ A	
No-load supply current	$I_0$	$\leq 17$ mA	
Switching state indication		LED, yellow	

#### Functional safety related parameters

MTTF <sub>d</sub>	1600 a
Mission Time ( $T_M$ )	20 a
Diagnostic Coverage (DC)	0 %

#### Ambient conditions

Ambient temperature	-25 ... 70 °C (-13 ... 158 °F)
---------------------	--------------------------------

#### Mechanical specifications

Connection type	cable PVC , 2 m
Core cross-section	0.14 mm <sup>2</sup>
Housing material	brass, nickel-plated
Sensing face	PBT
Protection degree	IP67

#### General information

Scope of delivery	2 self locking nuts in scope of delivery
-------------------	--

#### Compliance with standards and directives

Standard conformity	
Standards	EN 60947-5-2:2007 IEC 60947-5-2:2007

#### Approvals and certificates

UL approval	cULus Listed, General Purpose
CSA approval	cCSAus Listed, General Purpose
CCC approval	CCC approval / marking not required for products rated $\leq 36$ V