

Product Data Sheet



15XX SC

Replace XX with 02, 04, 06, 08 or 12 for number of poles
1500 Series with Short Circuiting Bar



8 pole shown

30 Amps, 600 Volts AC/DC
(Unprepared Wire)

or

75 Amps, 600 Volts AC/DC when wired
with Listed crimp type ring, spade or
fork terminal

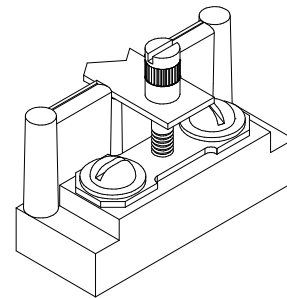

Short Circuiting Bar
with Shorting Pin

5/8" Line to Line Spacing

Wire Range (with unprepared wire):
#10 - 22 AWG Copper

Size and number of lugged wires investigated in end use.

Four (4) screws supplied per part for 1504, 1506, 1508 and 1512. Two (2) screws for 1502

Application torque – 20 in.lb.

Shorting Bar is designed for current transformer application. It is NOT intended to be used as a jumper for power circuits

See tables below for wire sizes.

Electrical Ratings:

- 30A (unprepared wire)
- 75A (when wired with crimp type ring, spade or fork terminal)
- 600 Volts AC/DC (UL 1059 Class C, User Group - General Industrial)
- Factory and Field Wiring
- Use Listed terminals and tools for field installation of prepared conductors

Mechanical Ratings:

- Maximum insulator base temperature: 150°C (302°F) UL RTI
- Storage and transportation temperature range: -35°C to 125°C (-31°F to 257°F)
- Flammability rating of insulator base: UL 94 V-0
 - Use outside these ratings needs to be judged in the end-use application.

Materials:

- Connector: Brass, nickel plated
- Insulator base: phenolic
- Screws: Brass, nickel plated, #10-32 combination Phillips-slotted standard
- Marking Strip: Vinyl (white)
- Marking strip anchor screws: Steel, zinc plated
- Short Circuit Bar: Brass, tin plated
- Insert: Brass
- Shorting Pin: Brass, nickel plated (supplied loose)

Agency Approvals:

- UL Recognized, UL 1059 Terminal Block Standard, File No. XCFR2.E62806
- CSA Certified, CSA C22.2 No. 158, File No. LR19766
- CE compliant to IEC 60947-7-1
- RoHS Compliant

- Panel mountable: #10 fastener, torque to 25-30 in. lbs.

Accessories:

- Additional Shorting Pins: 9616901
- Slotted Screw available
- Clear cover: Thermoplastic, UL Recognized QMFZ2 - order CC 15XX (XX representing number of poles). See Data Sheet CC 15XX

- Sems Pressure Saddle Screw with External Lock Washer (SPSE)
Wire range #10-18 Copper Sol/Str. 30 Amps max.



- Printing Available on Marking Strip:



Note: If making strip is ordered separately, order MS 15XX Side

Consult factory for custom printed applications

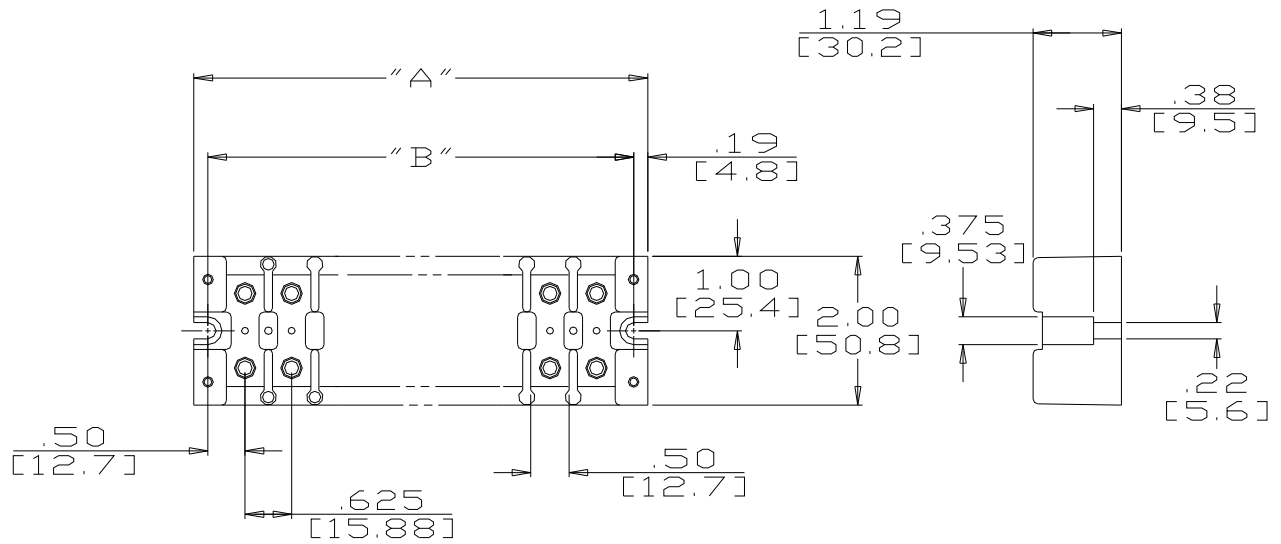

| Catalog # | # of Poles | A | B |
|-----------|------------|------|------|
| 1504 | 4 | 3.25 | 2.88 |
| 1506 | 6 | 4.50 | 4.12 |
| 1508 | 8 | 5.75 | 5.38 |
| 1512 | 12 | 8.25 | 7.88 |

MM = Dim X 25.4

WWW.MARATHONSP.COM
1-419-352-8441

PDS 0202 REV B 01/27/17